



Fuel Container Holder

First Time Installation

- Please read instructions carefully before installation.
- Check the contents of kit. Contact your Prorack dealer if any parts appear to be missing or damaged.
- Clean your roof racks and cargo tray prior to fitting the Fuel Container Holder.

Important Warning

- It is critical that all Prorack racks and accessories be properly and securely attached to your vehicle. Improper attachment could result in an automobile accident, and could cause serious bodily injury or death to you or to others.
- You are responsible for securing the racks and accessories to your car, checking the attachments prior to use, and periodically inspecting the products for adjustment, wear, and damage.
- If you do not understand all of the instructions and cautions, or if you have no mechanical experience and are not thoroughly familiar with the installation procedures, you should have the product installed by a professional installer such as a roof rack specialist.

Tools Required

- Allen Key (provided)
- 13 mm/16 mm Spanner
- 16 mm Socket + Socket Wrench (for dual side-by-side installation)

Kit Contents

Item	Component	Qty
1	Fuel Container Holder	1
2	Ratchet & Short Webbing Strap	1
3	Long Webbing Strap	1
4	M6 Capscrew Button Head	4
5	M6 Washer	8
6	M6 Nylock Nut	4
7	M10 x 25 mm Set Screw	2
8	M10 Spring Washer	2
9	M10 Washer	2
10	M10 Spring Nut	2
11	M10 x 20 mm Set Screw	2
12	M10 T-Nut	2
13	M8 x 16 mm Set Screw	2
15	M8 Spring Washer	2
15	M8 Washer	2
16	M8 T-Slot Nut	2
17	Holder Mounting Bracket	2
18	4 mm Allen Key	1

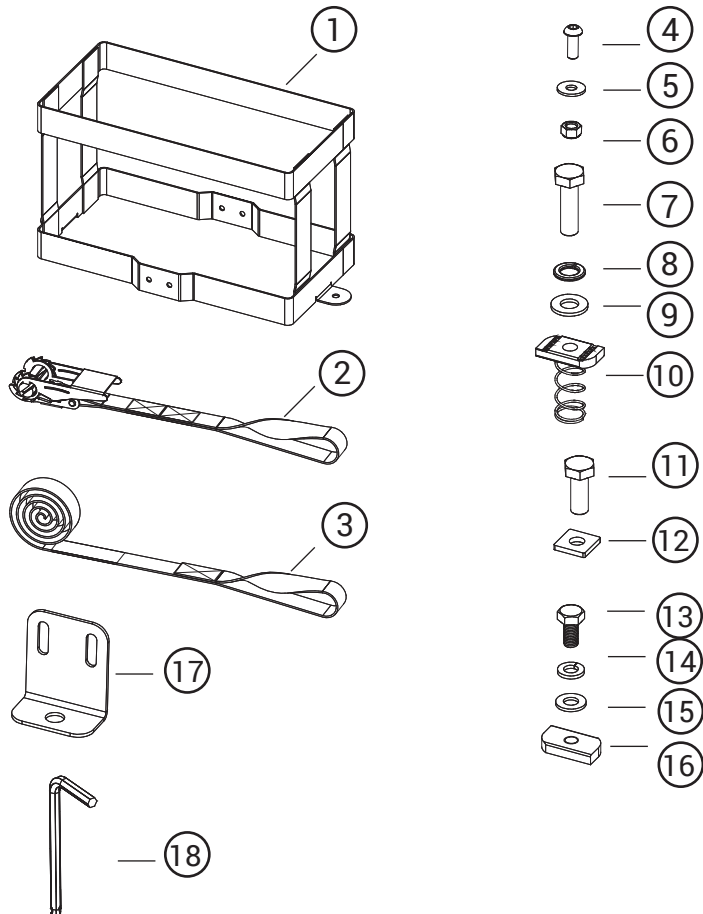

PR3205

Install to Standard Cargo Tray on Prorack HD, Tradesman and other Heavy Duty Crossbars

- 1** Turn the fuel container holder upside down and fit both mounting brackets on to the long side of the holder. Ensure brackets are fitted on the inside of the holder and that the screw heads face inwards. Tighten capscrews with Allen key to 4-5 Nm.

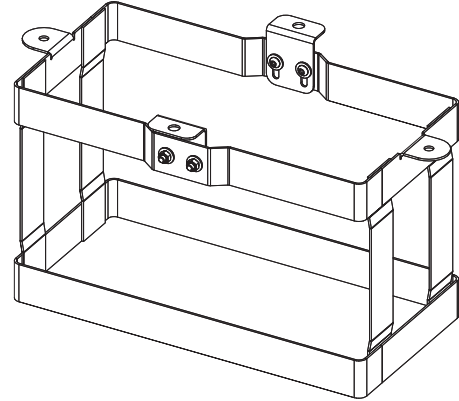
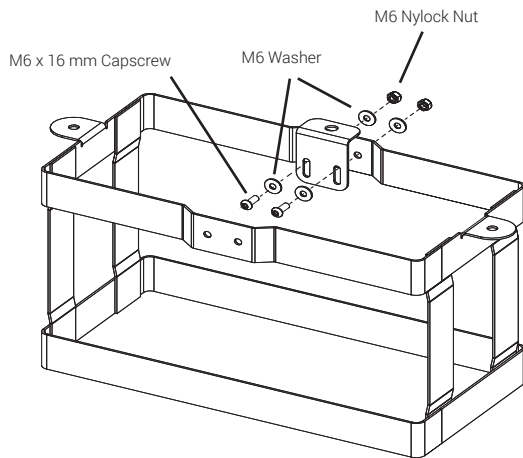

- 2** Position 2x M10 spring nuts into the crossbar channel either side of tray slat where holder will be positioned. Push spring nuts down into crossbar channel and twist to lock into place.

Use the assembled holder from step 1 to ensure spring nuts align with holes in brackets.

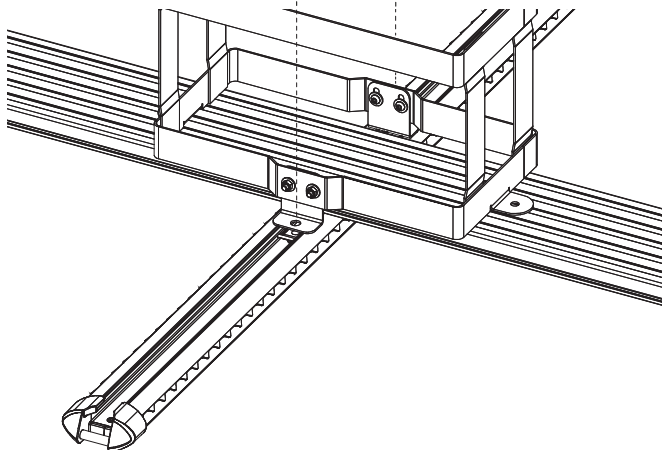
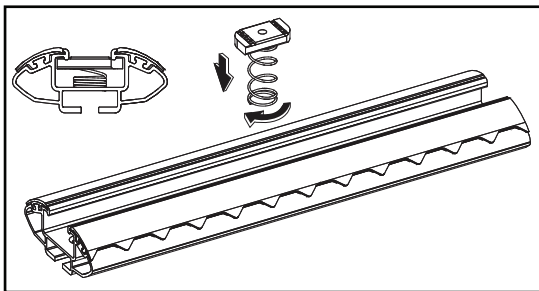

- 3** Secure each mounting bracket on to the spring nuts in the crossbar using 2x M10 x 25 mm set screws, 2x M10 spring washers and 2x M10 washers. Use a 16 mm spanner to tighten screws to 4-5 Nm.

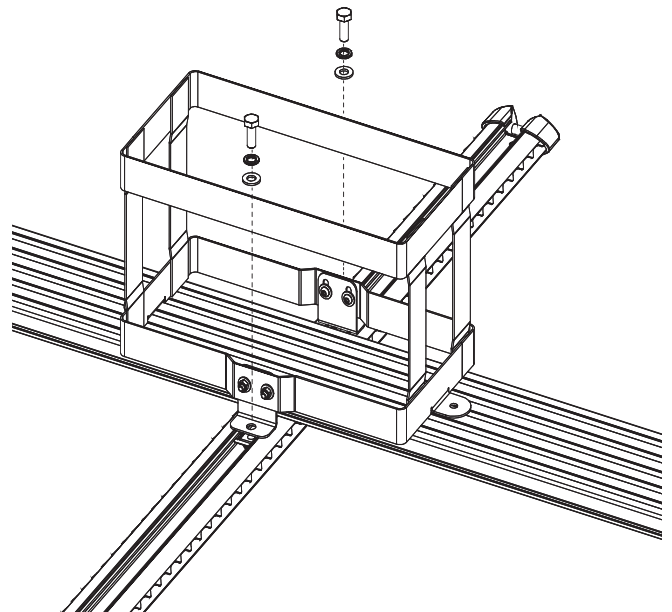

Install to Standard Cargo Tray on Prorack S-Wing and International T-Slot Crossbars

- 1** Turn the fuel container holder upside down and fit both mounting brackets on to the long side of the holder. Ensure brackets are fitted on the inside of the holder and that the screw heads face inwards. Tighten capscrews with Allen key to 4-5 Nm.

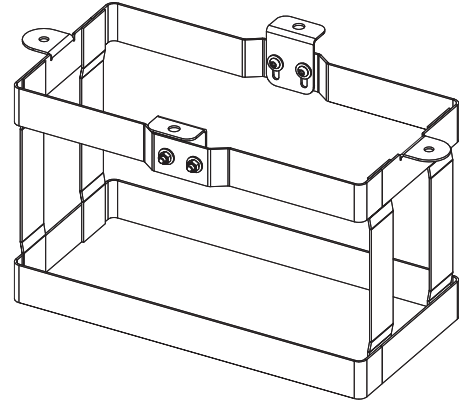
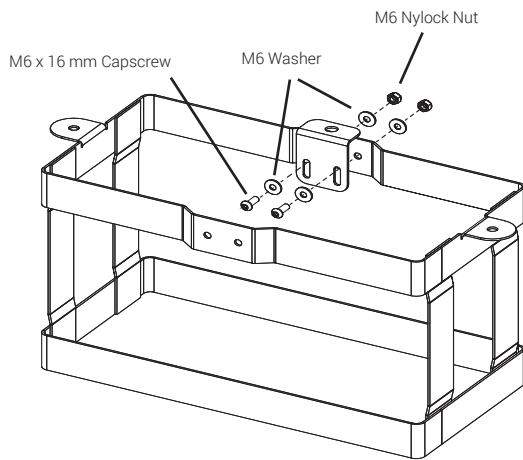

- 2** Push rubber infill down and slide 2x M10 T-nuts into the crossbar channel either side of tray slat where holder will be positioned.

Use the assembled holder from step 1 to ensure T-nuts align with holes in brackets.

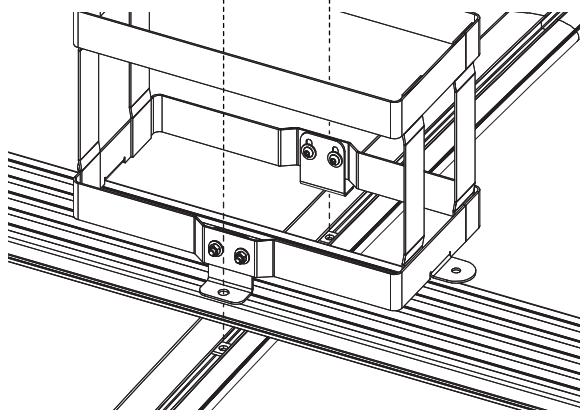
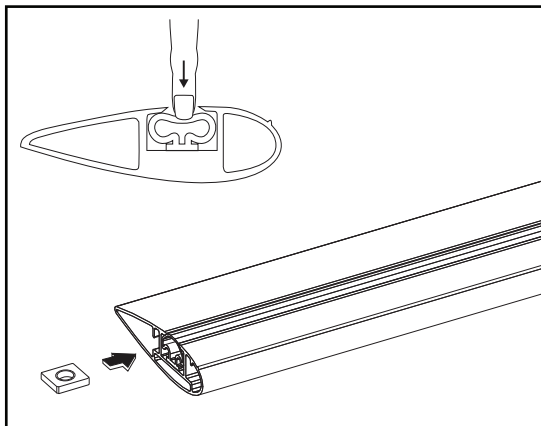

- 3** Secure each mounting bracket on to the T-nuts in the crossbar using 2x M10 x 20 mm set screws, 2x M10 spring washers and 2x M10 washers. Use a 16 mm spanner to tighten screws to 4-5 Nm.

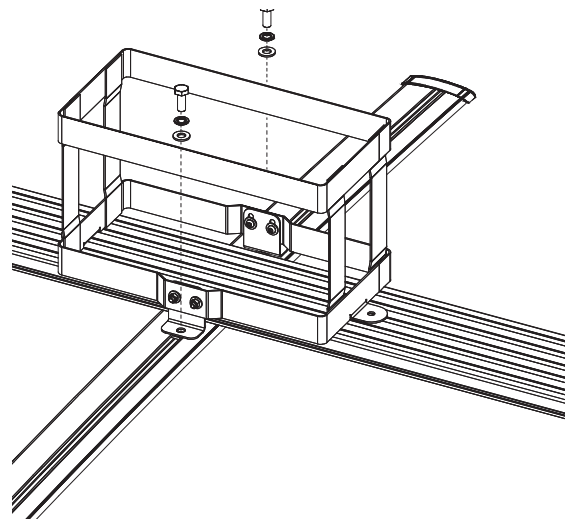

Install to Cargo Tray with T-Slot Channels

- 1 Slide 2x M8 nuts into the T-slot of the tray.

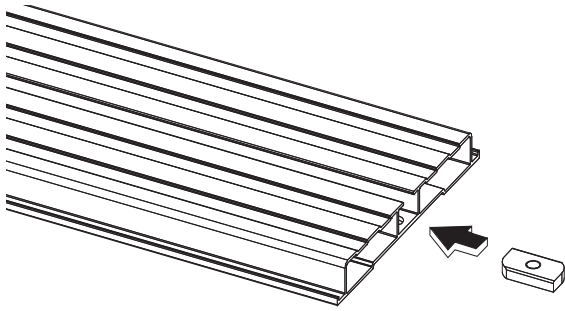

- 2 Position holder centrally over a crossbar in the preferred position. Secure the fuel container holder on to the M8 nuts in the T-slot using 2x M8 x 16 mm set screws, 2 x M8 spring washers and 2x M8 washers. Use a 13 mm spanner to tighten screws to 4-5 Nm.

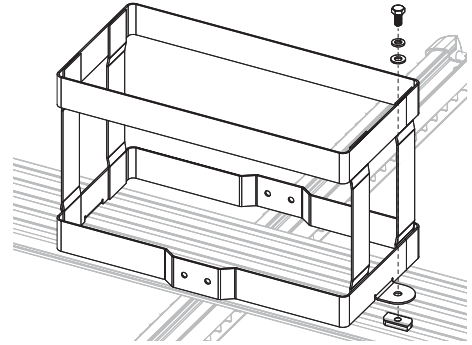

Securing the Fuel Container

- 1 Place the fuel container vertically into the holder ensuring the filler cap is facing upwards as shown.

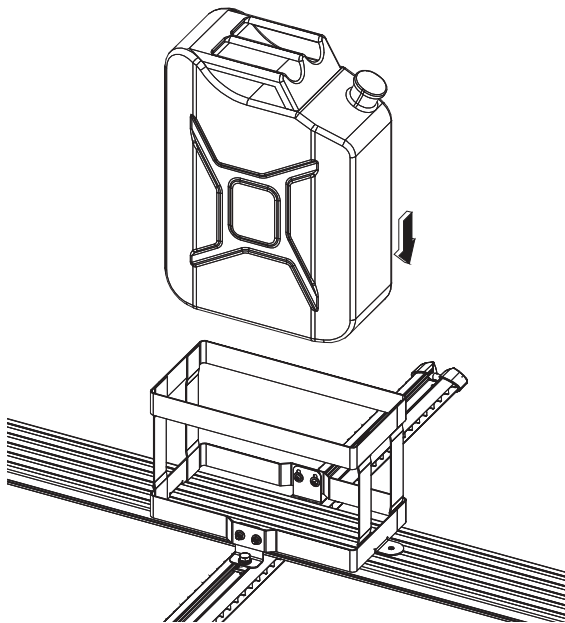

- 2 Loop the ratchet through the handle in the short strap around the crossbar on one side of the holder and loop the long strap through its handle around the crossbar on the other side of the holder.

Secure the holder with the straps and ratchet provided.

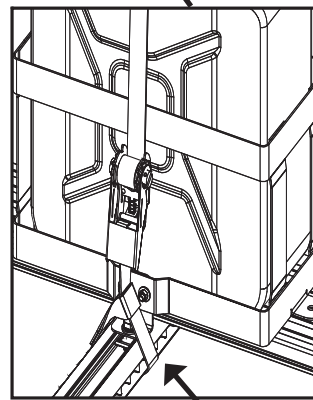
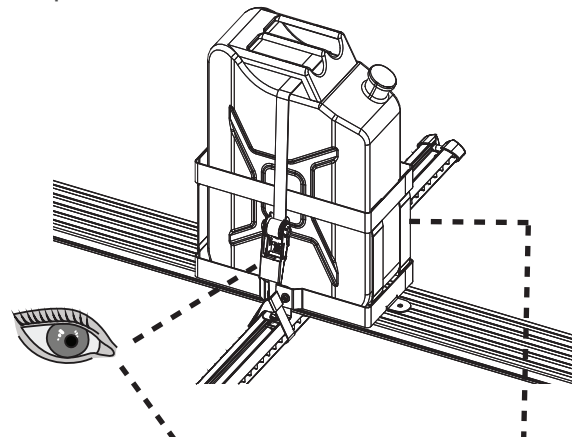

Ratchet is looped around crossbar and through itself

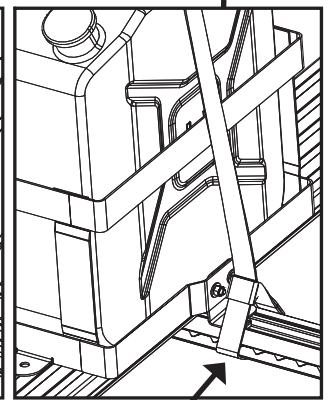

Strap is looped around crossbar and through itself

Installing Dual Fuel Container Holders

For this configuration, one mounting bracket will be required to sit on the other as shown. Adjust position of the mounting brackets to ensure both holders sit flat on the cargo tray.

Using an M10 x 25 mm set screw, an M10 spring washer and an M10 washer, assemble the two holders on to the spring nut or T-nut in the crossbar channel. Use a 16 mm socket & socket wrench to tighten the set screw to 4-5 Nm.

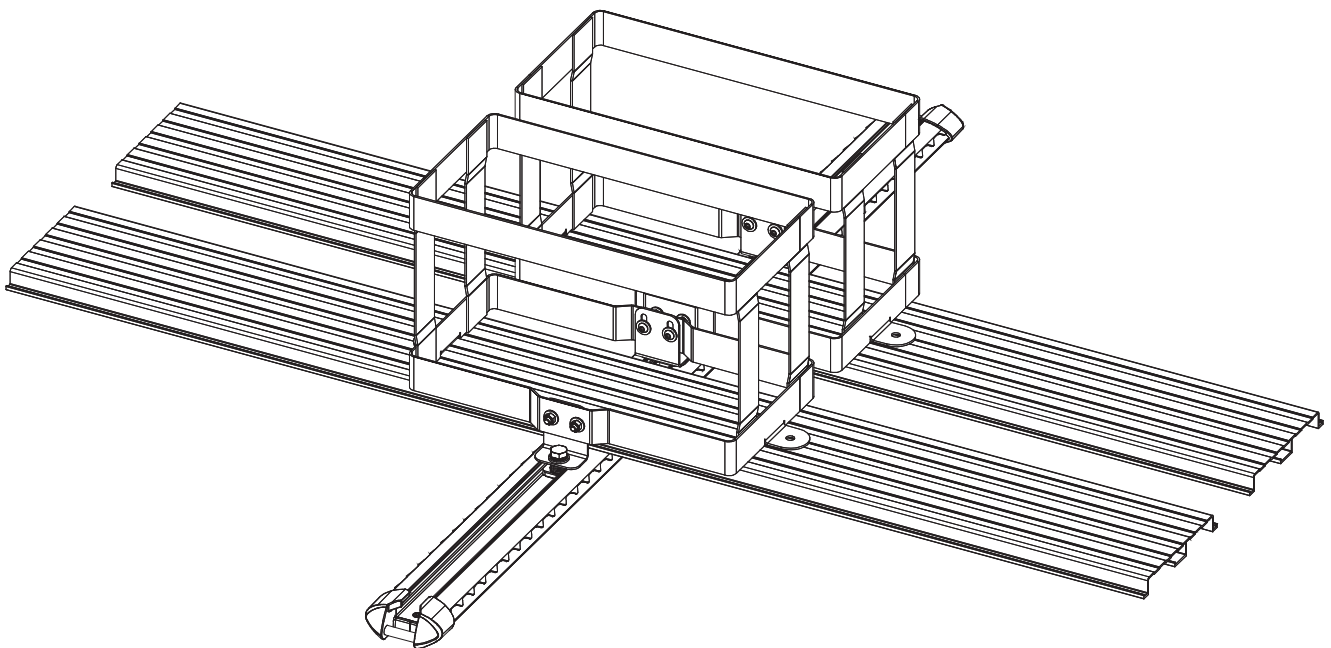
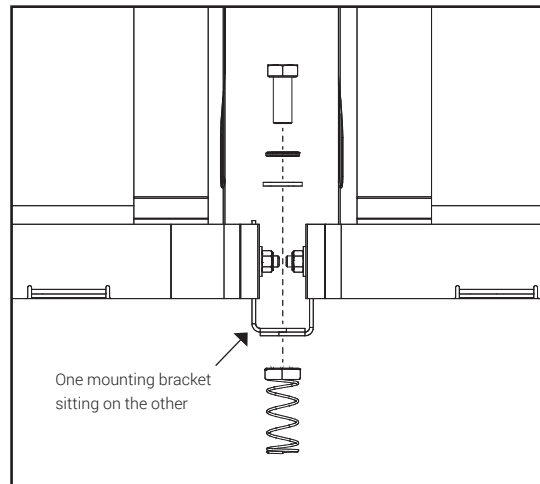

Maintenance

- Check accessory is securely attached whenever you refit it to the vehicle. If the unit feels loose, refer to the fitting instructions and readjust.
- Regularly check all fasteners. This includes all attached accessories and roof racks.
- If straps become contaminated with oil, fuel or acid remove with hot soapy water.
- If the ratchet mechanism becomes stiff in use, a small amount of lubrication applied to the moving parts will ease operation.

Caution

- Ensure all loads are distributed evenly across the roof racks and are fastened securely.
- A loaded roof rack system can alter the performance of your vehicle. Be especially aware of the effects of side winds, changing of direction, and braking performance. Avoid rapid acceleration and deceleration. Drive carefully.
- Make sure all loads are securely fastened with non-elastic straps. Check regularly during longer journeys.
- Never drive into a car wash with the roof rack system fitted.
- Do not exceed the vehicle manufacturer's roof load rating. Total load equals weight of roof racks + accessories + cargo/ equipment.
- Ratcheting strap must not be used for lifting. Protect from abrasion and friction. Do not tie knots in the straps. Do not use a damaged strap.
- 150 kg lashing capacity on the polypropylene webbing.



Prorack
17 Hinkler Court, Brendale
QLD 4500, Australia

Freephone
AU: 1800 143 548 www.prorack.com.au
NZ: 0800 4776 722 www.prorack.co.nz