



Bike Fork Mount Carrier

First Time Installation

- Please read instructions carefully before installation.
- Check the contents of kit. Contact your Prorack dealer if any parts appear to be missing or damaged.
- Clean your roof racks prior to fitting the basket.

Important Warning

- It is critical that all Prorack racks and accessories be properly and securely attached to your vehicle. Improper attachment could result in an automobile accident, and could cause serious bodily injury or death to you or to others.
- You are responsible for securing the racks and accessories to your car, checking the attachments prior to use, and periodically inspecting the products for adjustment, wear, and damage.
- If you do not understand all of the instructions and cautions, or if you have no mechanical experience and are not thoroughly familiar with the installation procedures, you should have the product installed by a professional installer such as a roof rack specialist.

BlockHead attaches securely to flat surfaces. Recommended Mounting Hardware includes 6 mm (1/4") bolts or screws, fender washers, and locking nuts

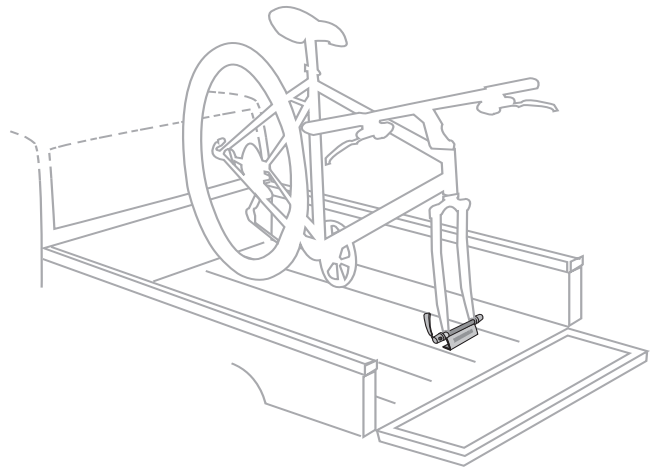
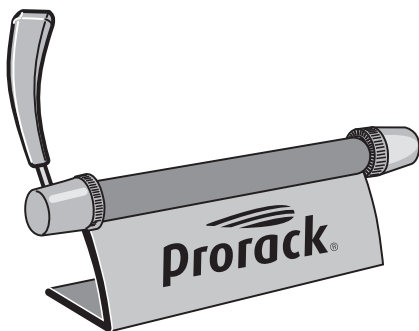

- 1** Remove the skewer from the block by loosening the nut

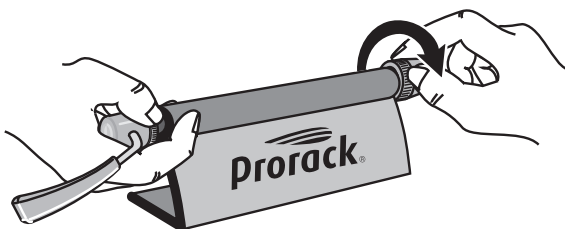

- 2** Use the template below to scribe two drilling points

- Use 6 mm (1/4") mounting hardware.
- Always check handlebar clearance before attaching block.

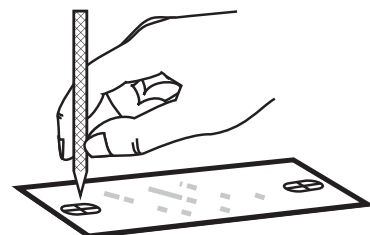

3 Align block with drilled holes

Pivot the bolts or screws into place.



4 Tighten hardware securely.

Test installation by pulling and shaking.



Replace skewer and attach the nut.

5 Set the bicycle forks onto the skewer.

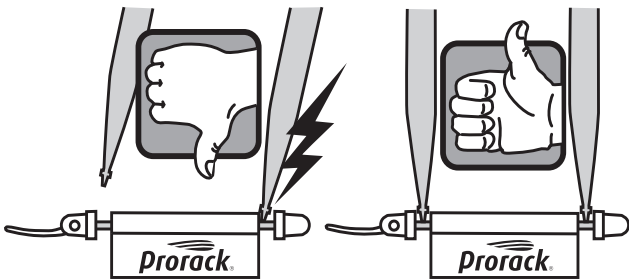

6 With lever open, tighten nut until the lever closes with some resistance.

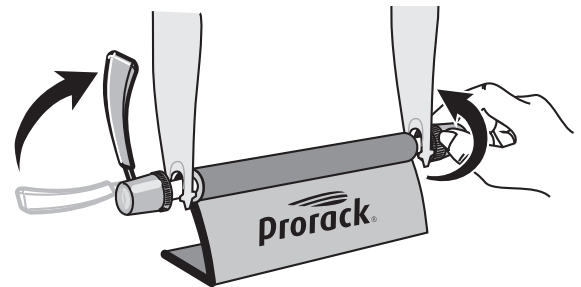

Loosen or tighten the nut as needed so that lever closes with some resistance.



Test security by tugging at forks. If forks can move out of the skewer, open lever and tighten the nut slightly

Close lever again with firm pressure. Repeat if necessary.

Check the template against the block before drilling

TEMPLATE

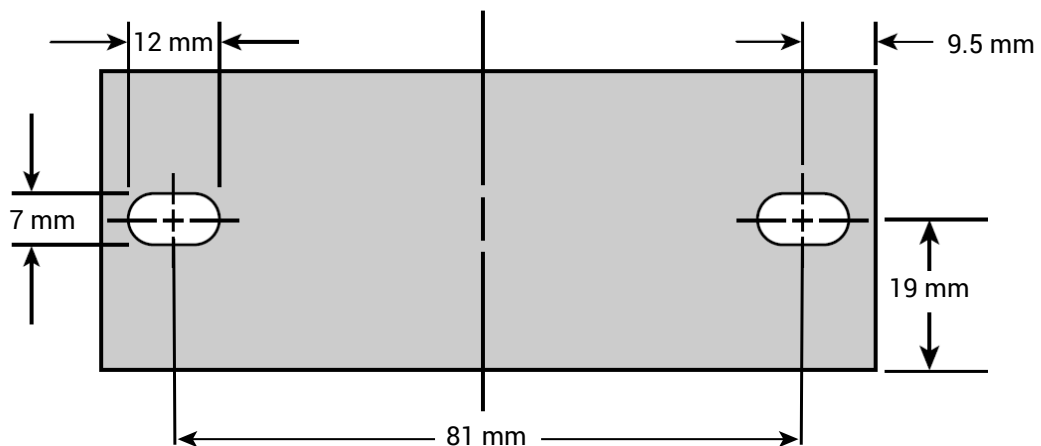

Maintenance

- Check accessory is securely attached whenever you refit it to the vehicle. If the unit feels loose, refer to the fitting instructions and readjust.
- Regularly check all fasteners. This includes all attached accessories and roof racks.
- Clean with hot soapy water and sponge as required.
- Lubricate skewer occasionally.

Caution

- Make sure all loads are securely fastened. Check regularly during longer journeys.
- Never drive into a car wash with the bike attached to the system.
- Do not exceed the vehicle manufacturer's load rating.



Prorack
17 Hinkler Court, Brendale
QLD 4500, Australia

Freephone
AU: 1800 143 548
NZ: 0800 4776 722

www.prorack.com.au
www.prorack.co.nz