



# Recovery Track Mount

## First Time Installation

- Please read instructions carefully before installation.
- Check the contents of kit. Contact your Prorack dealer if any parts appear to be missing or damaged.
- Clean your roof racks or Prorack Aero Deck prior to fitting the Recovery Track Mount.

## Important Warning

- It is critical that all Prorack racks and accessories be properly and securely attached to your vehicle. Improper attachment could result in an automobile accident, and could cause serious bodily injury or death to you or to others.
- You are responsible for securing the racks and accessories to your car, checking the attachments prior to use, and periodically inspecting the products for adjustment, wear, and damage.
- If you do not understand all of the instructions and cautions, or if you have no mechanical experience and are not thoroughly familiar with the installation procedures, you should have the product installed by a professional installer such as a roof rack specialist.

## Tools Required

- 13 mm Spanner
- 13 mm Socket and Ratchet  
(Baseplate to bar installation only)
- Torque Wrench (optional)
- Tape Measure
- Padlock (optional)

## Note - this product is optimised to work with the following recovery tracks:

- Maxtrax MkII
- Tred 1100 mm & 800 mm



RECOVERY TRACKS SOLD SEPARATELY

## Contents

- Installation of Recovery Track Mount Mounting Brackets on Prorack Aero Deck  
Go to Page 3
- Installation of Recovery Track Mount Mounting Brackets on Prorack Aero Bars and International T-Slot Crossbars  
Go to Page 7
- Installation of Recovery Track Mount Mounting Brackets on Prorack Heavy Duty, Trade and other Heavy Duty Crossbars  
Go to Page 10
- Installing Recovery Track Mount Baseplates to Prorack Recovery Track Mount Brackets  
Go to Page 14
- Installing Recovery Track Mount Baseplates direct to Prorack Aero Bars and International T-Slot Crossbars  
Go to Page 17
- Installing Recovery Track Mount Baseplates direct to Prorack Heavy Duty, Trade and other Heavy Duty Crossbars  
Go to Page 20
- Installing Locking Strap  
Go to Page 23
- Installing Prorack Awning Bracket to Prorack Recovery Track Mount Mounting Brackets  
Go to Page 23
- Installing Prorack Universal Mount to Prorack Recovery Track Mount Mounting Brackets  
Go to Page 23

**PR3718**

### Kit Contents

Item	Component	Qty	Item	Component	Qty
1	Accessory Bracket	2	10	M8 x 25 Button Head Capscrew	4
2	Prorack Recovery Track Baseplate	2	11	M8 Slot Nut	4
3	Fixed Strap Assembly	2	12	M8 Aero Bar Nut	2
4	Adjuster Strap Assembly	2	13	M8 Nyloc Nut	6
5	Locking Strap	1	14	M8 Oval Washer	4
6	T-Bolt Slot M8 Self Aligning	4	15	M8 Round Washer	6
7	M8 x 16 Button Head Capscrew	2	16	M8 Spring Washer	4
8	M8 x 18 Button Head Capscrew	2	17	Allen Key 5 mm	1
9	M8 x 20 Button Head Capscrew	2			

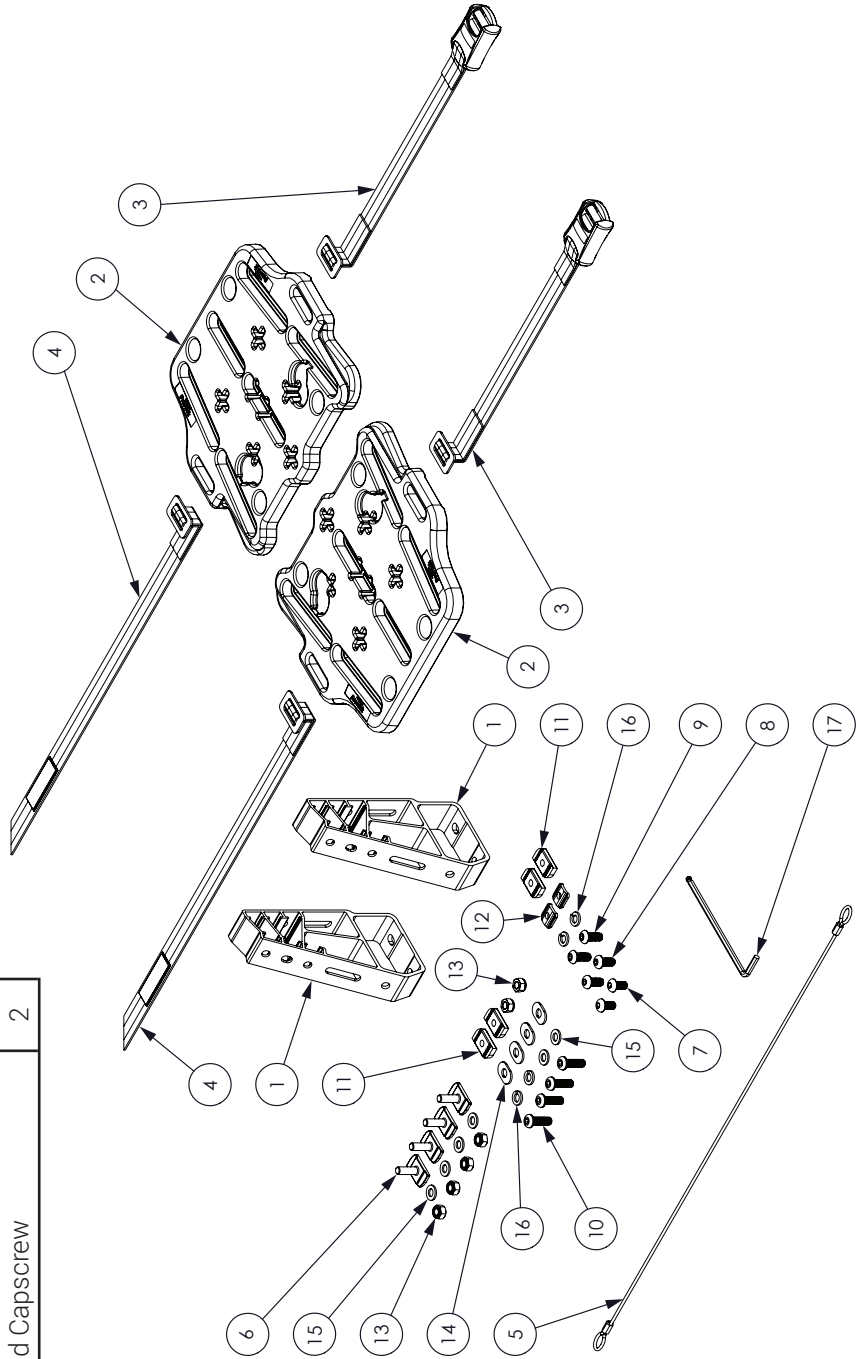

## Bracket Installation to Prorack Aero Deck

### Vertical Mount Bracket install - "Flat face out" or "Angled face out"

#### 1 POSITION MOUNTING T-BOLTS

Check that the spread between the slats is between 492mm and 892mm.  
Insert x2 T-Bolts into the Aero Deck Side Perimeter Beam and into the Aero Deck Slat to suit the bracket position. Repeat for the second mounting bracket.

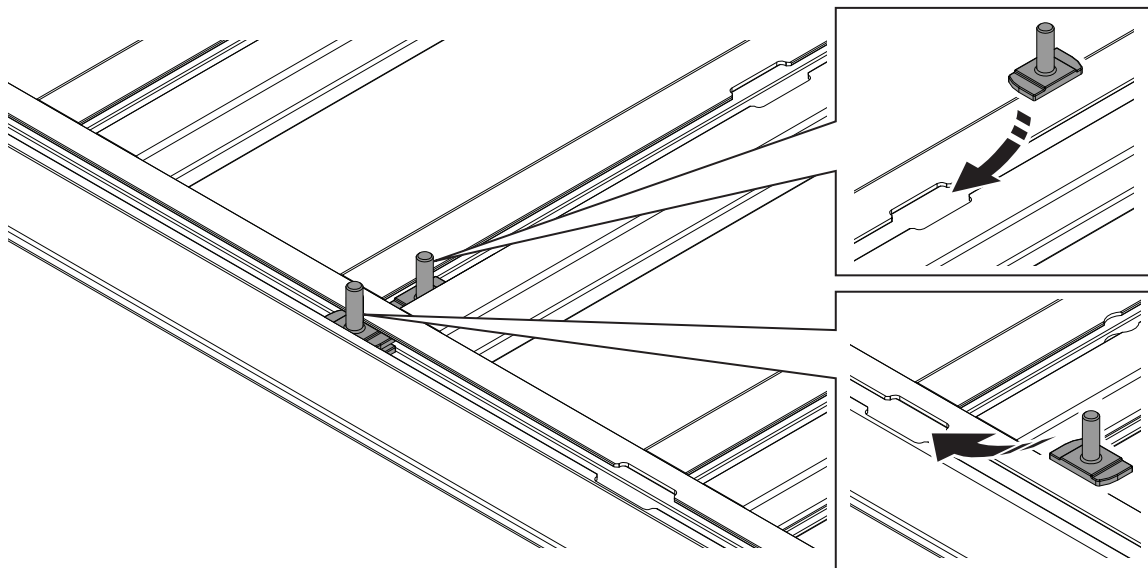

#### 2 ATTACH BRACKET

Position the Bracket on to the T-Bolts noting the two possible vertical mounting positions available. Install the M8 Nyloc Nuts and M8 Round Washers on to the T-Bolts after positioning the Bracket.

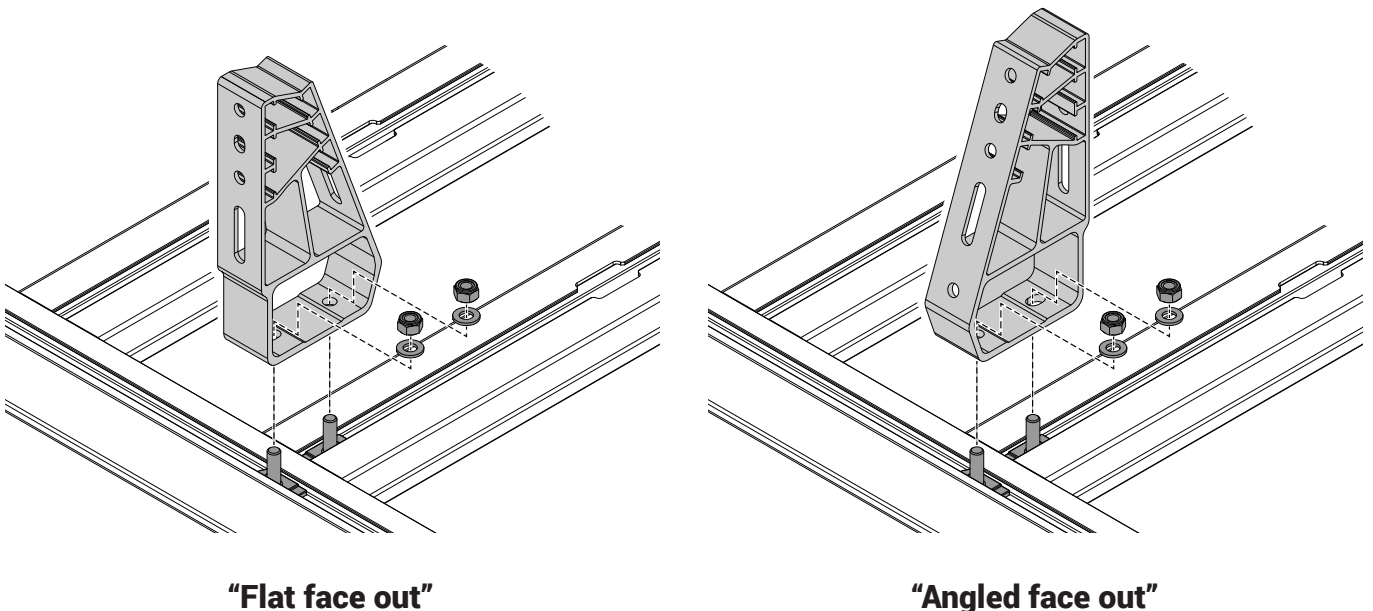

### 3 SECURE

Tighten the Nyloc Nuts to 4 Nm using a 13mm spanner.

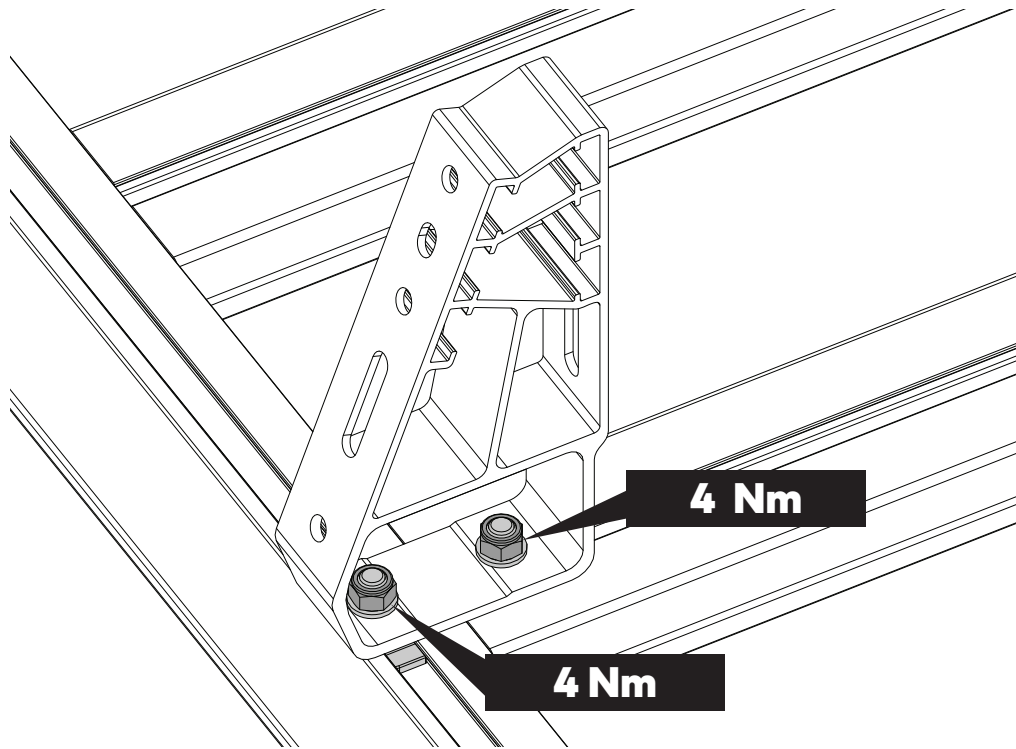

Continue to page 14 to mount the base plates to the brackets.

### Shallow Angle Bracket install - "Vertical face in"

#### 1 POSITION MOUNTING HARDWARE

Check that the spread between the slats is between 492mm and 892mm.

Insert x1 Slot Nut into the Aero Deck Side Perimeter Beam or Aero Deck Slat. Insert x1 T-Bolt into the Aero Deck Slat. Adjust to suit the bracket position. Repeat for the second mounting bracket.

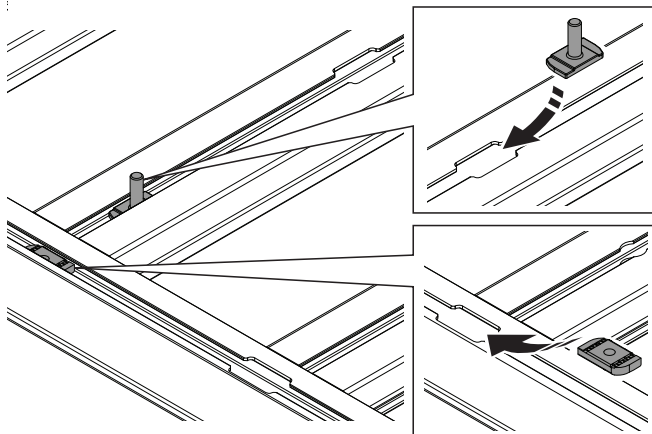

"Install to outer beam and slat"

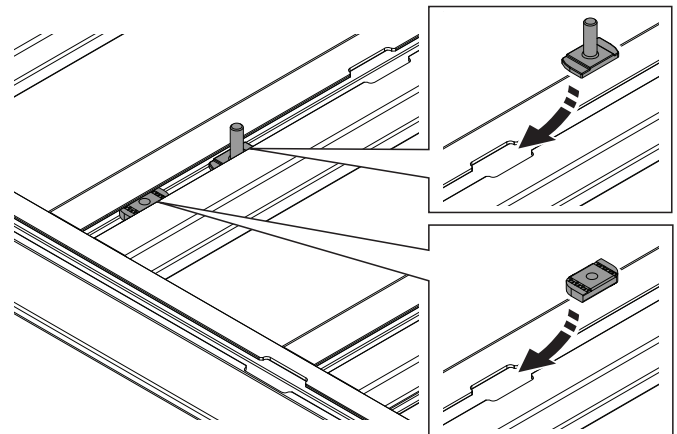

"Alternative install to slats only"

## 2 ATTACH BRACKET

Position the Bracket on to the T-Bolts noting the 'face in' mounting position. Install the M8 x 18 mm Capscrew, M8 Spring Washer and M8 Round Washer to the Slot Nut. Install the M8 Nyloc Nut and M8 Round Washers on to the T-Bolt after positioning the Bracket.

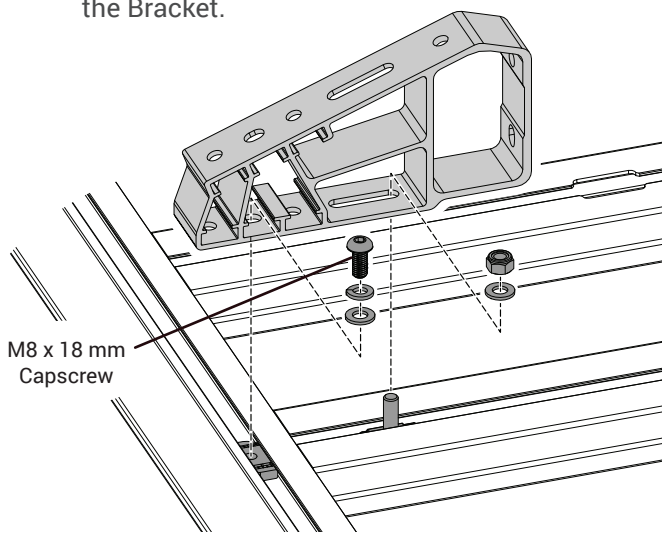

**"Install to outer beam and slat"**

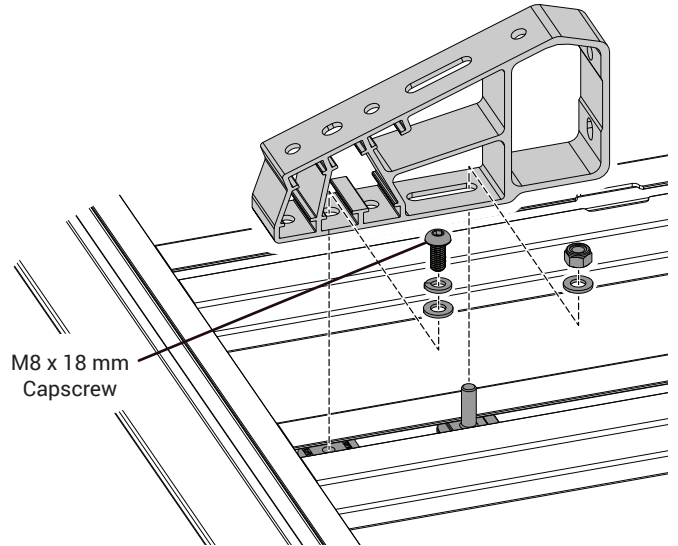

**"Alternative install to slats only"**

## 3 SECURE

Tighten the screw to 4 Nm using the supplied 5 mm Allen Key though the top hole as shown. Tighten the Nyloc Nut to 4 Nm using a 13mm spanner.

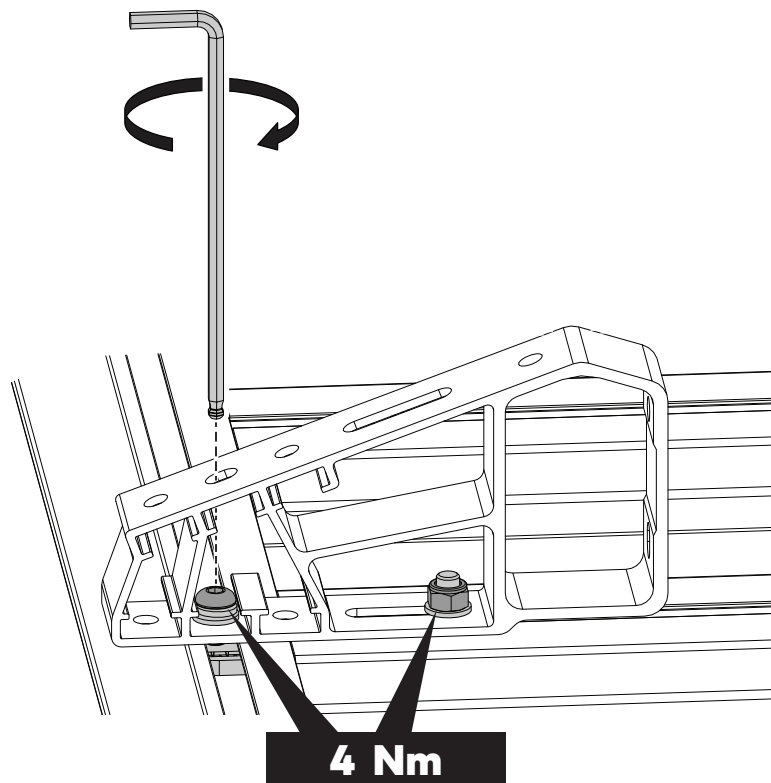

Continue to page 14 to mount the base plates to the brackets.

## Shallow Angle Bracket install - "Vertical face out" for awning mounting

### 1 POSITION MOUNTING HARDWARE

Check that the spread between the slats is between 492mm and 892mm.

Insert x1 T-Bolt into the Aero Deck Side Perimeter Beam and x1 Slot Nut into the Aero Deck Slat to suit the bracket position. Repeat for the second mounting bracket.

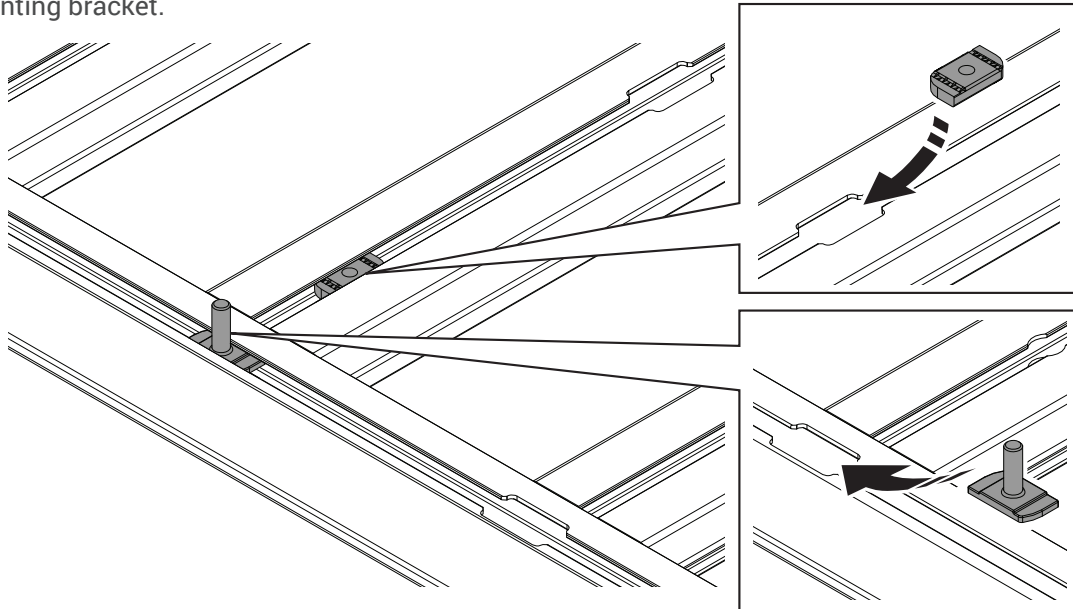

### 2 ATTACH BRACKET

Position the Bracket on to the T-Bolt and Slot Nut noting the 'vertical face out' mounting position. Install the M8 x 18 mm Capscrew, M8 Spring Washer and M8 Round Washer to the Slot Nut. Install the M8 Nyloc Nut and M8 Round Washers on to the T-Bolt.

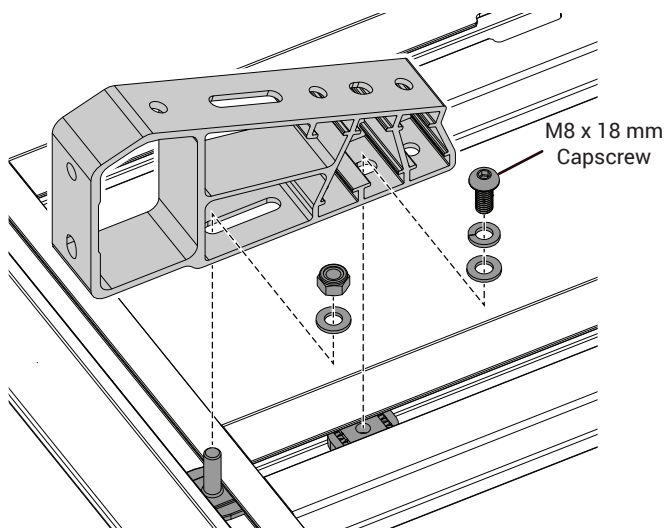

### 3 SECURE

Tighten the screw to 4 Nm using the supplied 5 mm Allen Key through the top hole as shown. Tighten the Nyloc Nut to 4 Nm using a 13mm spanner.

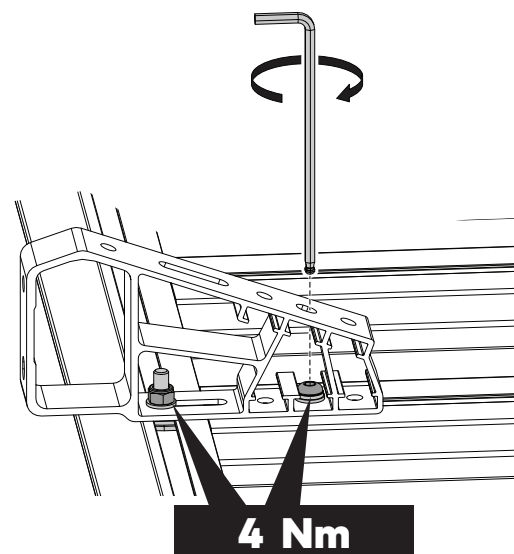

Continue to page 14 to mount the base plates to the brackets.

## Bracket Installation to Prorack Aero Bar

### Vertical Mount Bracket install - "Flat face out" or "Angled face out"

#### 1 POSITION T-BOLTS

Check that the spread between the crossbars is between 492mm and 892mm. Insert x2 T-Bolts into the T-Channel of the Aero Bar crossbar. Depress the crossbar infill and slide the T-Bolts to suit the bracket position. Repeat for the second mounting bracket.

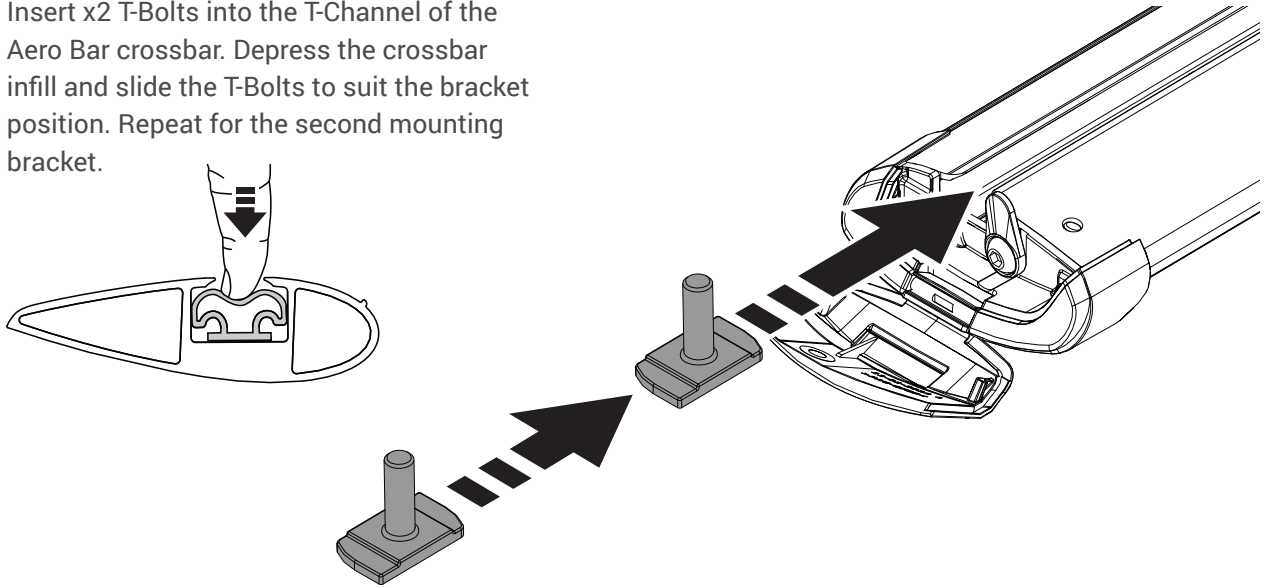

#### 2 ATTACH BRACKET

Position the Bracket on to the T-Bolts noting the two possible vertical mounting positions available. Install the M8 Nyloc Nuts and M8 Round Washers on to the T-Bolts after positioning the Bracket.

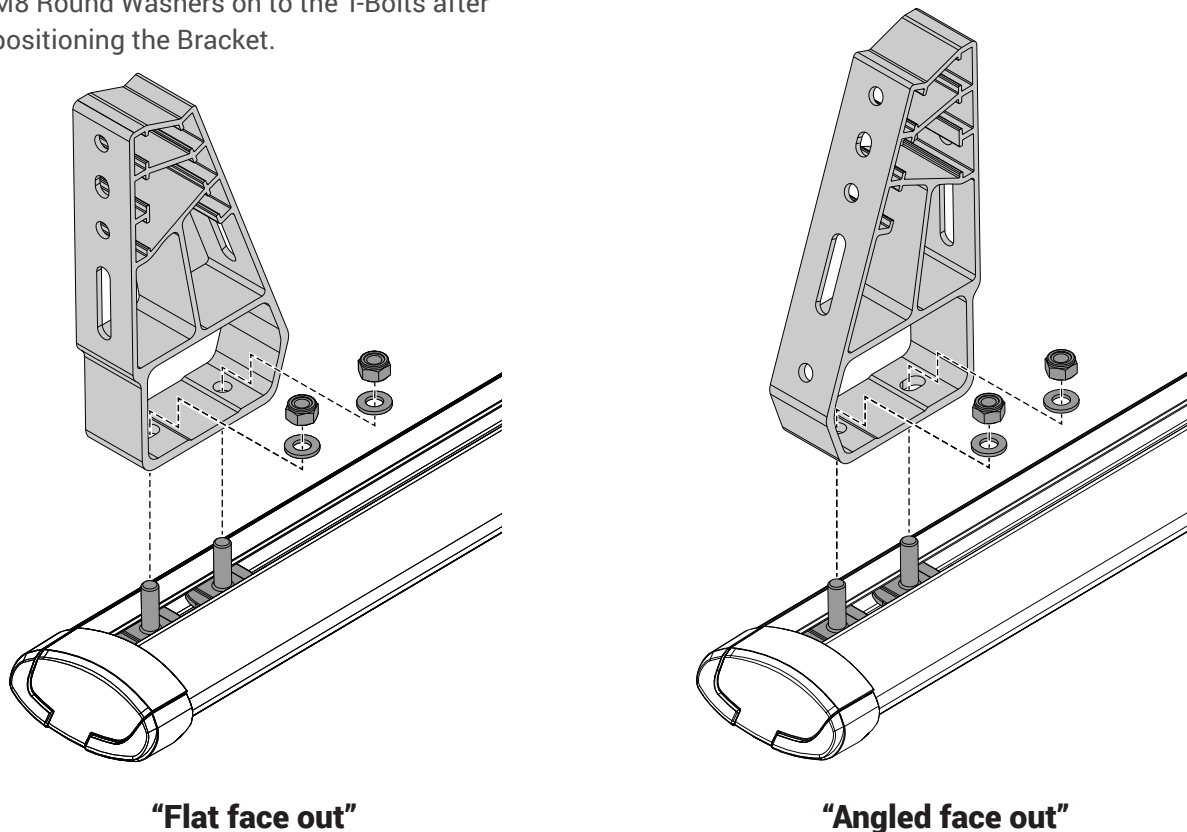

"Flat face out"

"Angled face out"



### 3 SECURE

Tighten the Nyloc Nuts to 4 Nm using a 13mm spanner.

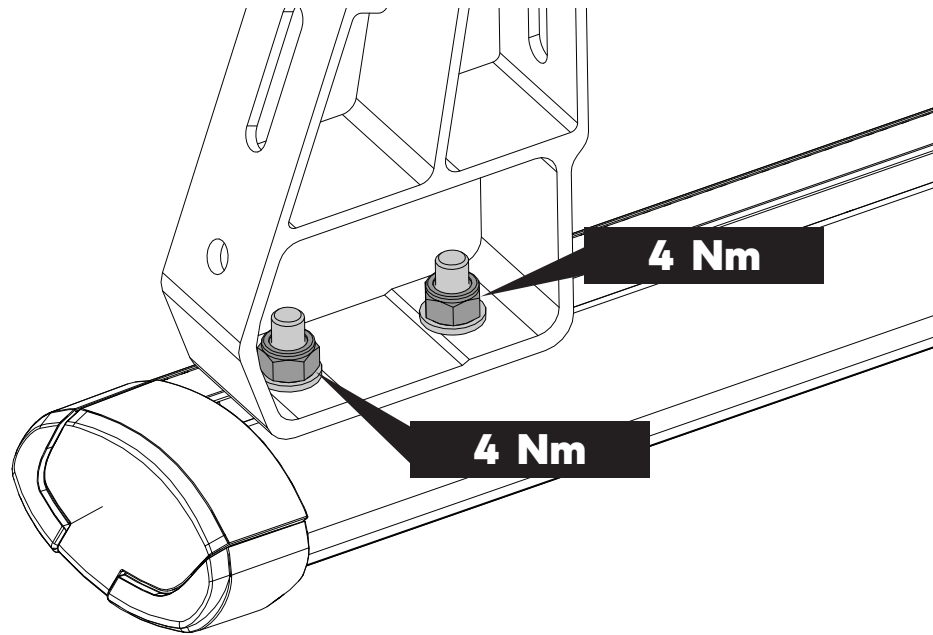

Continue to page 14 to mount the base plates to the brackets.

### Shallow Angle Bracket install - "Vertical face in" or "Vertical face out (Awning Option)"

#### 1 POSITION MOUNTING HARDWARE

Check that the spread between the crossbars is between 492mm and 892mm.

Depress the rubber infill down and slide x1 T-Bolt and then x1 Aero Bar Nut into each crossbar channel to suit the Bracket mounting in the order shown for the desired bracket position. The 5 mm Allen Key can be used to assist with the Aero Bar Nut installation. Repeat for the second mounting bracket.

Install the fasteners with the Aero Bar Nut then the T-Bolt for the Awning Mounting option.

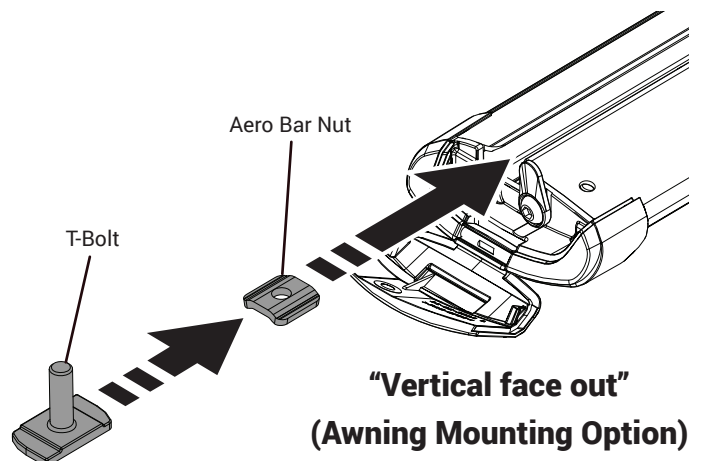
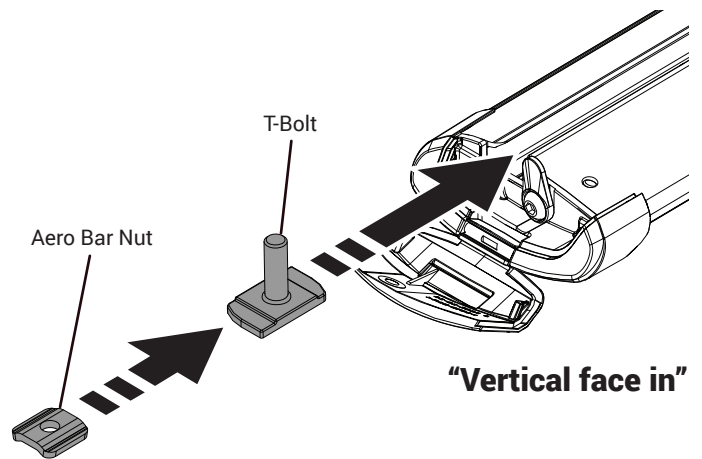
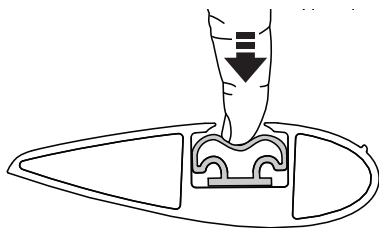



## 2 ATTACH BRACKET

Position the Bracket on to the T-Bolt and Slot Nut noting the “vertical face in” or “vertical face out” (Awning Mounting Option) mounting positions. Install the M8 x 16 mm Capscrew, M8 Spring Washer and M8 Round Washer to the Slot Nut. Install the M8 Nyloc Nut and M8 Round Washers on to the T-Bolt.

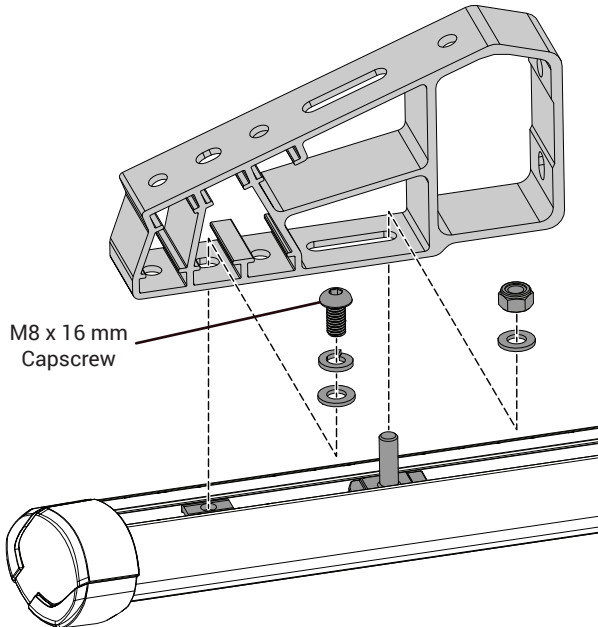

“Vertical face in”

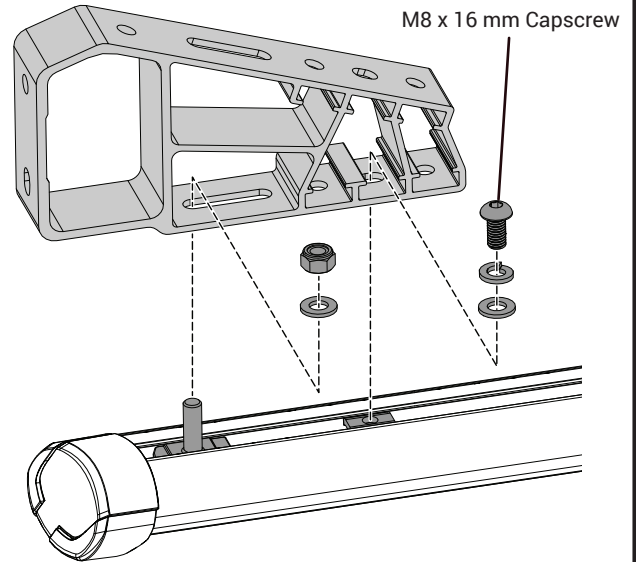

“Vertical face out”  
(Awning Mounting Option)

## 3 SECURE

Tighten the screw to 4 Nm using the supplied 5 mm Allen Key though the top hole as shown. Tighten the Nyloc Nut to 4 Nm using a 13mm spanner.

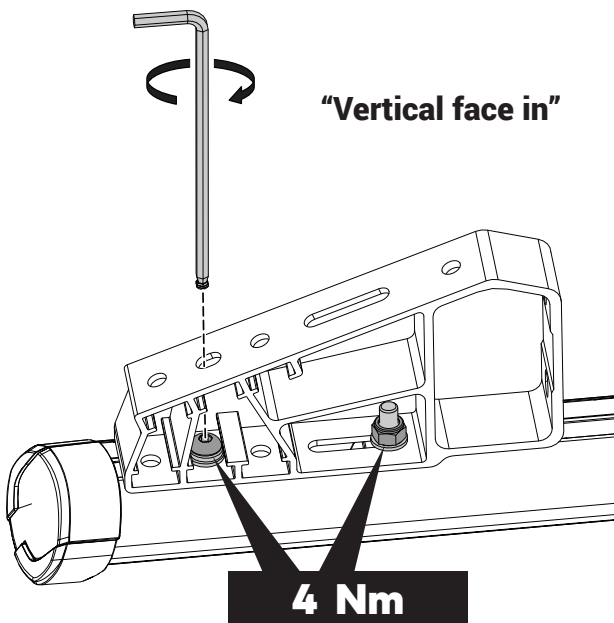

4 Nm

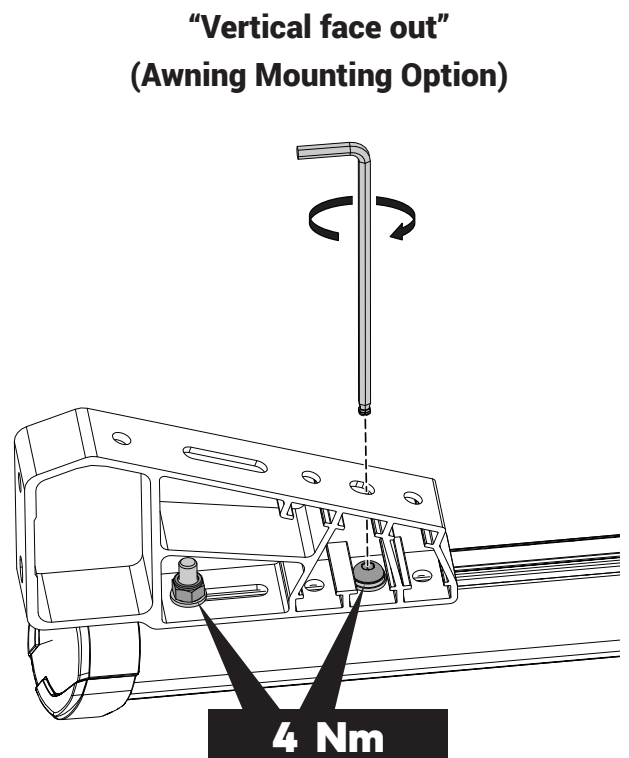

4 Nm

Continue to page 14 to mount the base plates to the brackets.

# Bracket Installation to HD Bars

## Vertical Mount Bracket install - "Flat face out" or "Angled face out"

### 1 ASSEMBLE PARTS

Assemble the T-Bolts, M8 Washers and M8 Nyloc Nuts onto the Accessory Bracket.

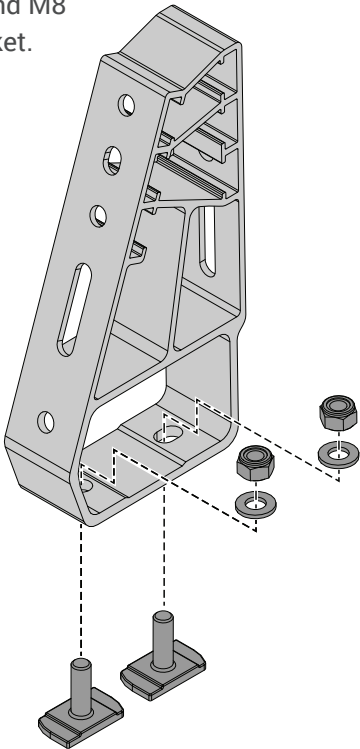

### 2 POSITION BRACKET

Rest the Accessory Bracket on the crossbar with the T-Bolt inside the T-Channel noting the two possible vertical mounting positions available.

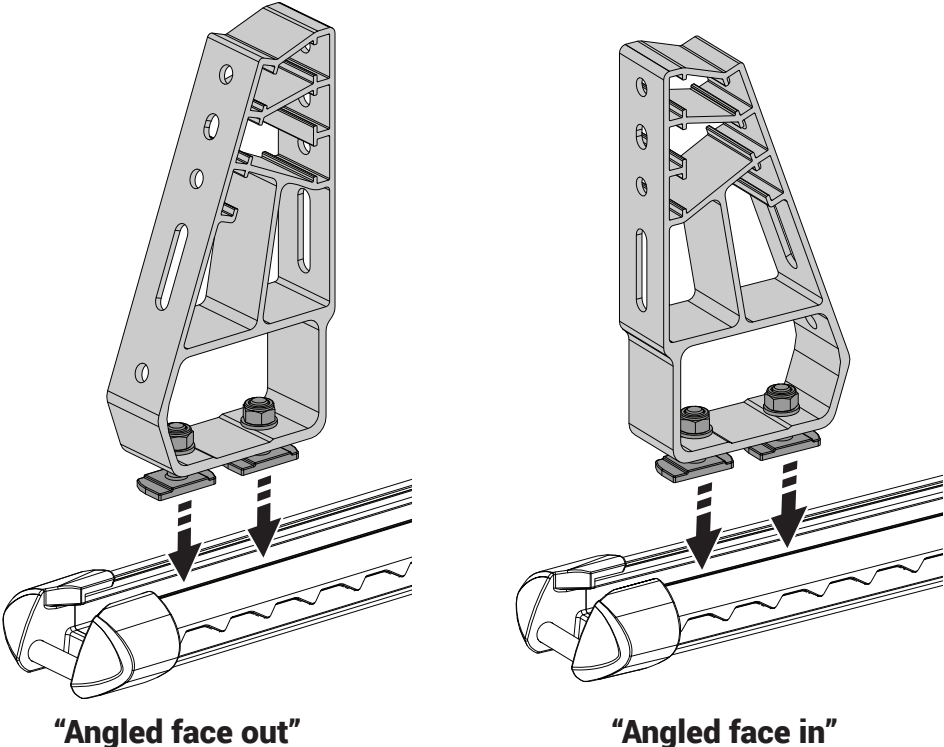

### 3 ATTACH BRACKET

Rotate the T-Bolts so that they turn 90° inside the T-Channel.

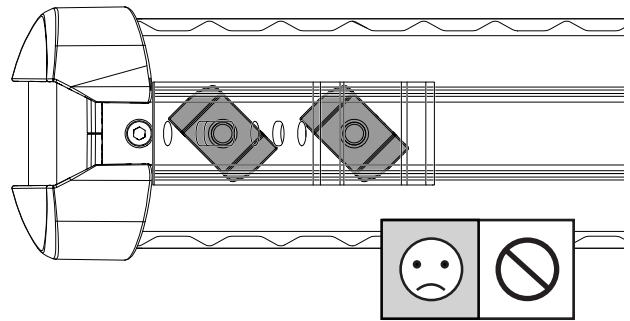
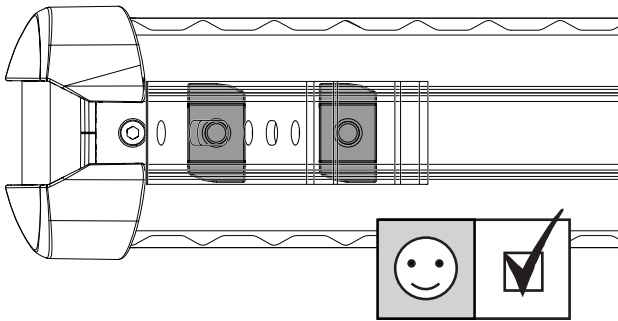
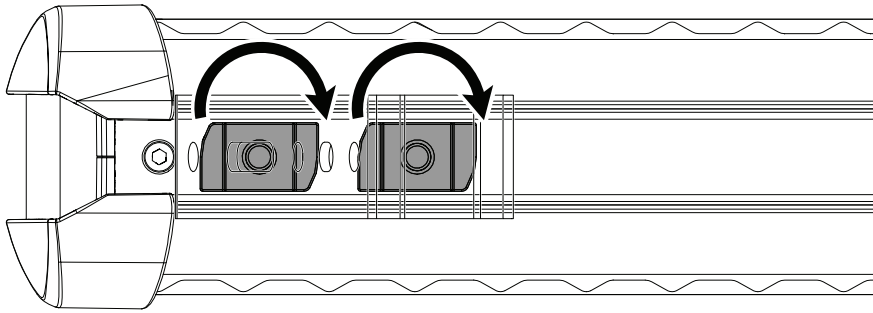

### 4 SECURE

Tighten the fasteners to 4 Nm using a 13mm spanner.

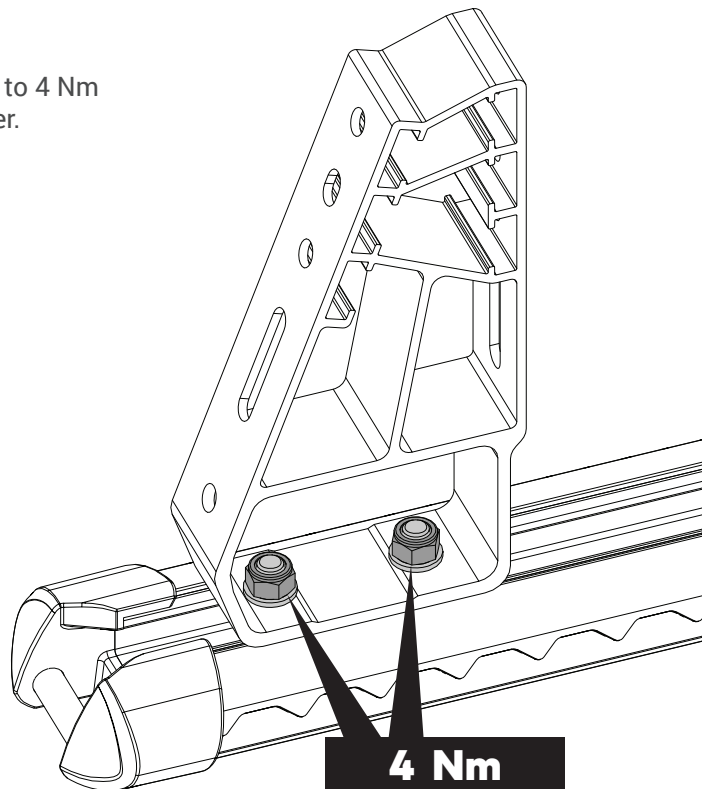

Continue to page 14 to mount the base plates to the brackets.

## Shallow Angle Bracket install - "Angled face out" or "Angled face in" (Awning Option)

### 1 ASSEMBLE PARTS

Loosely assemble the Accessory Bracket by installing the M8x20 mm Capscrew, M8 Spring Washer, M8 Round Washer and M8 Slot Nut onto the narrow end of the bracket into the middle of the three slots. Assemble the T-Bolt, M8 Round Washer and M8 Nyloc Nut into the slot as shown.

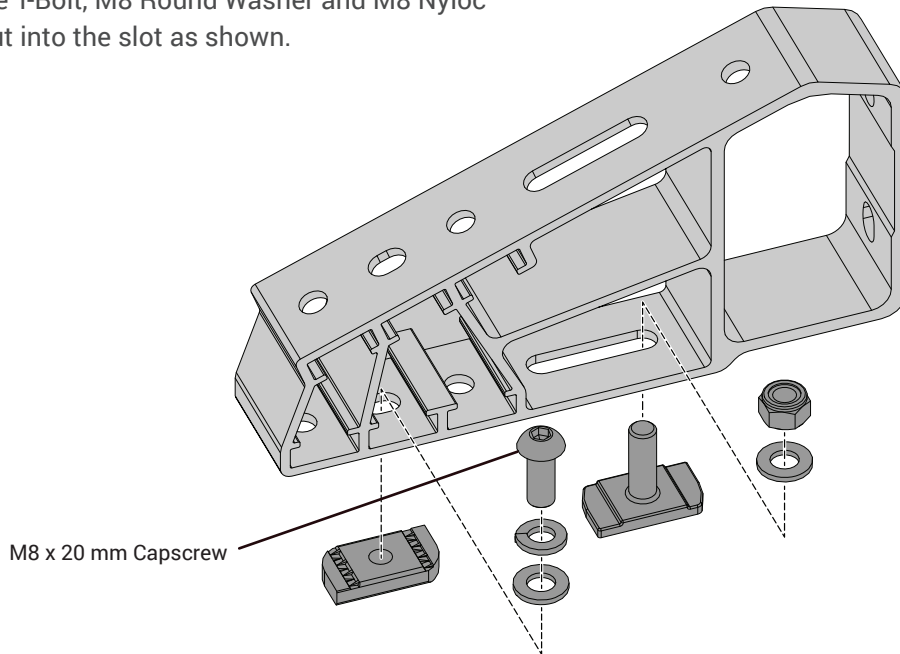

### 2 POSITION BRACKET

Rest the Accessory Bracket on the crossbar with the T-Bolt and Slot Nut inside the crossbar T-Channel noting the two possible mounting positions available..

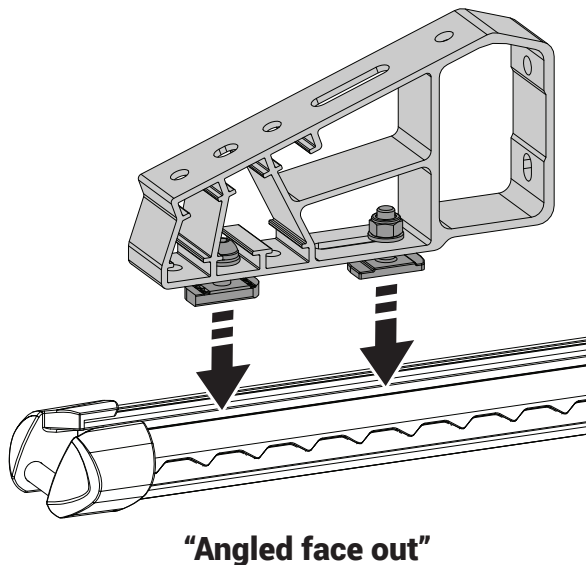

"Angled face out"

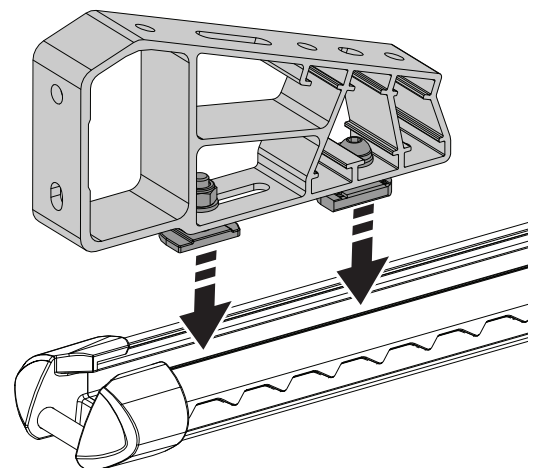

"Angled face in"  
(Awning Mounting Option)

### 3 ATTACH BRACKET

Rotate the Slot Nut and T-Bolt so that they turn 90° inside the T-Channel.

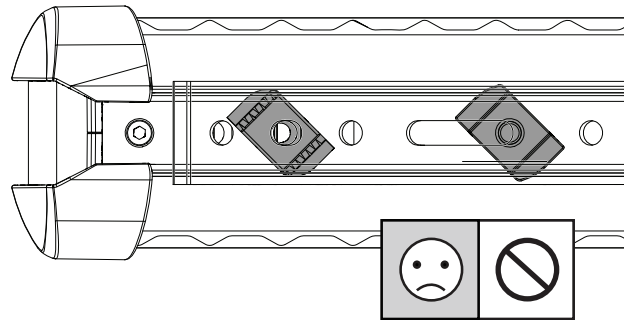
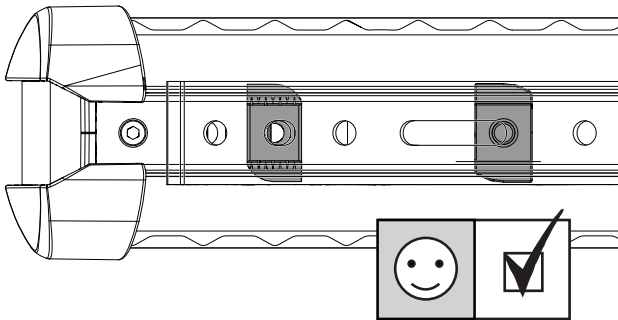
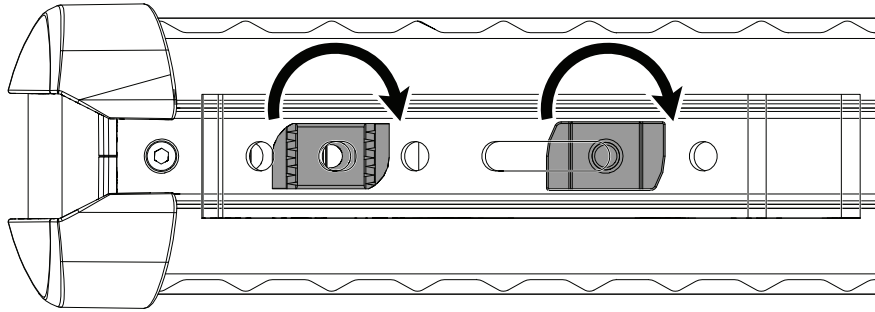

### 4 SECURE

Tighten the screw to 4 Nm using the supplied 5 mm Allen Key through the top hole as shown. Tighten the Nyloc Nut to 4 Nm using a 13mm spanner.

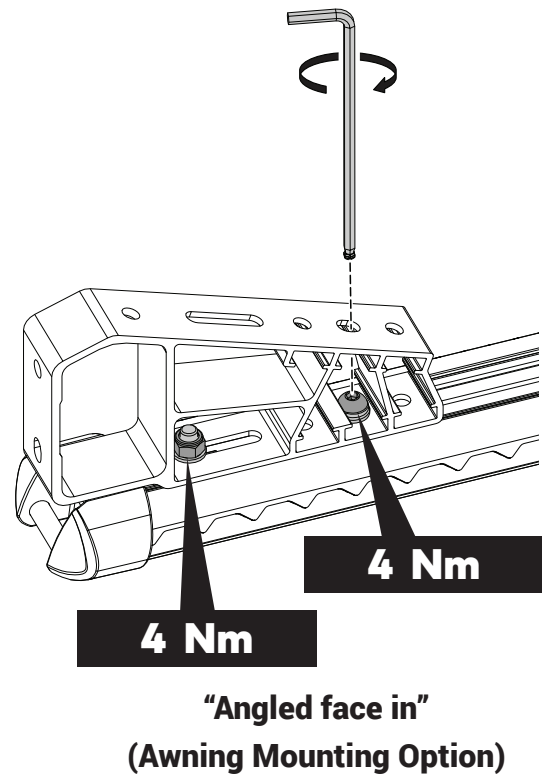
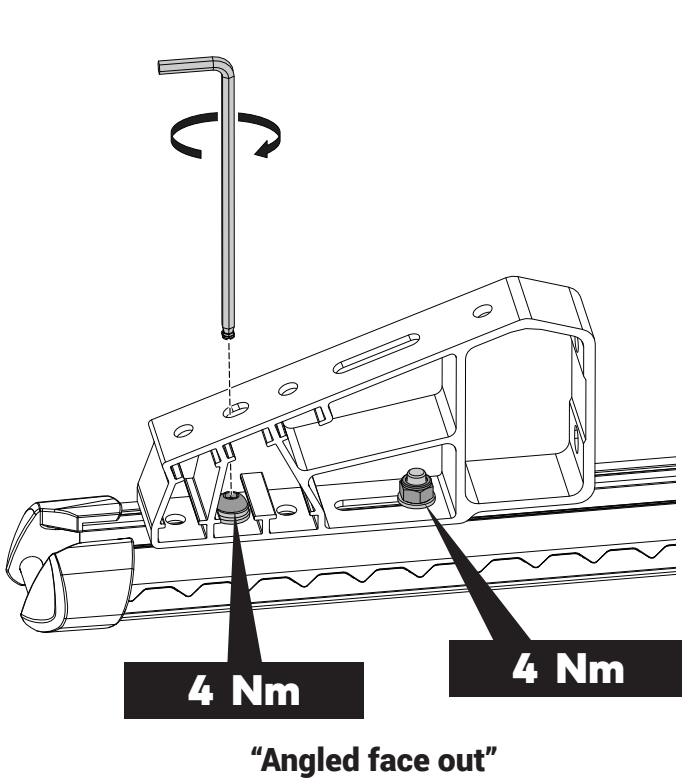

Continue to page 14 to mount the base plates to the brackets.

## Baseplate Installation to Brackets

### Baseplate installation to Brackets

Slot nut , Washers, Spring Washer, Screws and Nyloc Nuts required.

#### 1 BACKPLATE WIDTH

Determine the width the plates need to be spaced

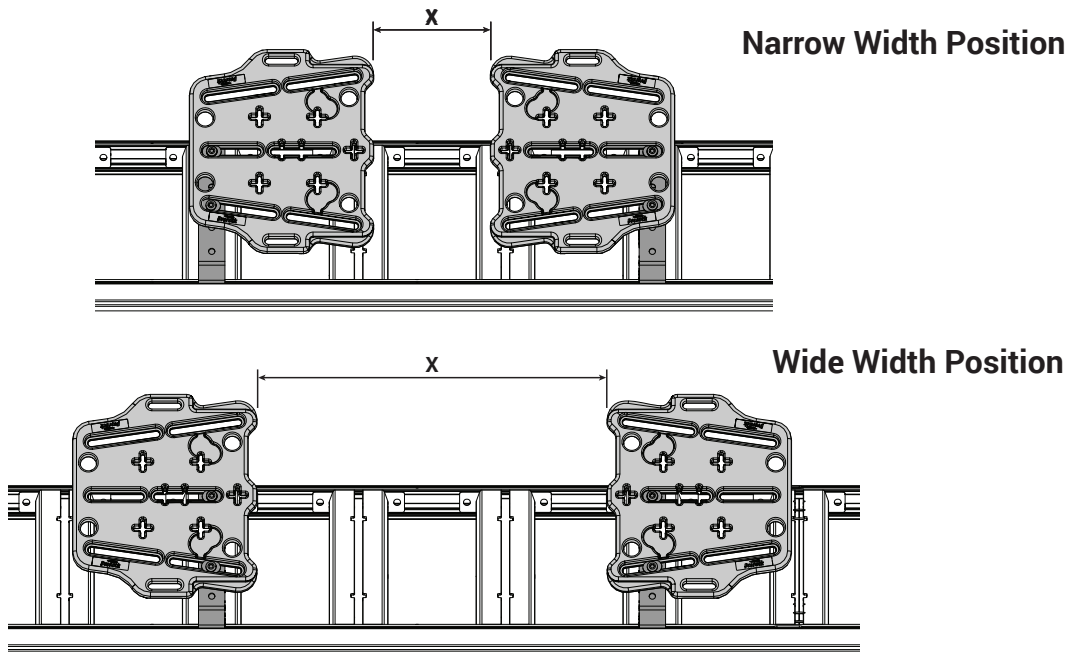

#### 2 BACKPLATE HEIGHT

Check the height to be positioned.

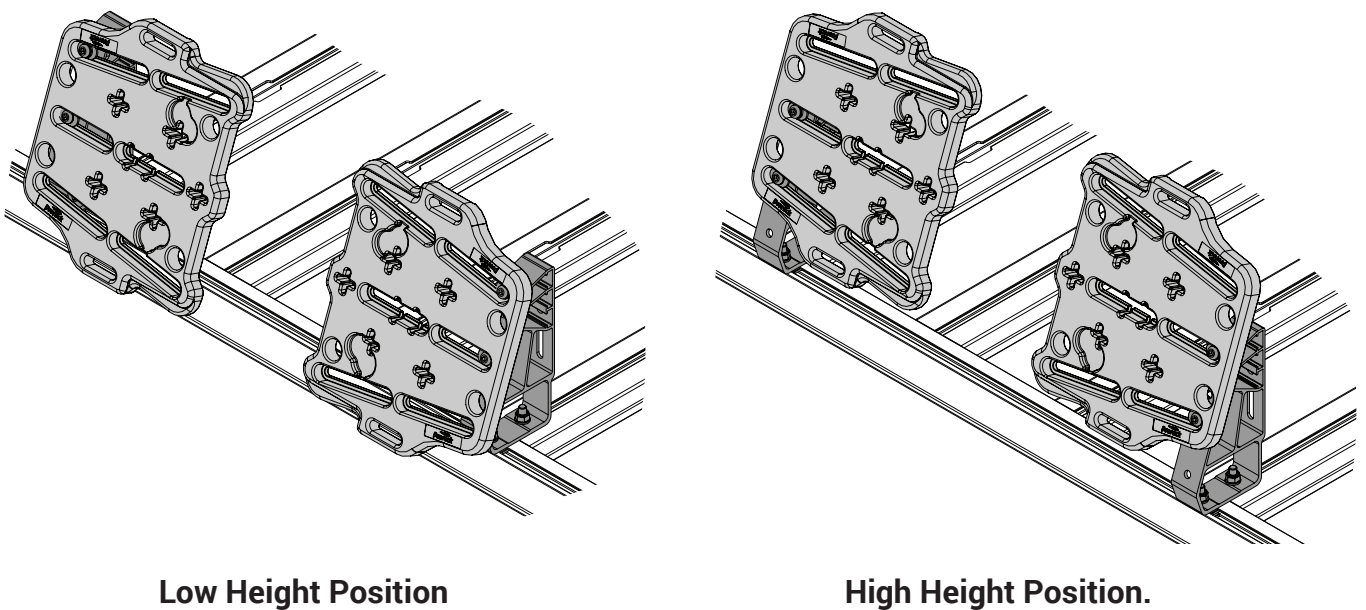



### 3

## ASSEMBLE PARTS

Assemble the M8 Slot nuts , M8 Round Washers, M8 Oval Washers, M8 Spring Washers, M8 Oval Washers, M8 Spring Washers, M8 x 25 mm Capscrews and Nyloc Nuts onto the Baseplate and Accessory Bracket as shown.

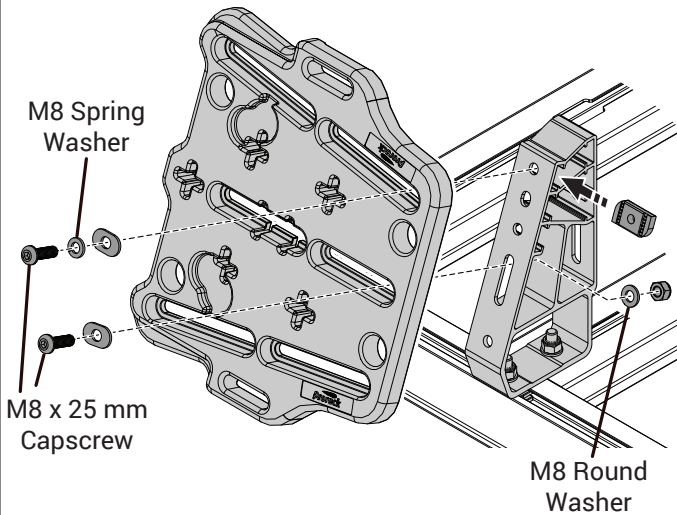

**Vertical Mount Low Height Position Assembly.**

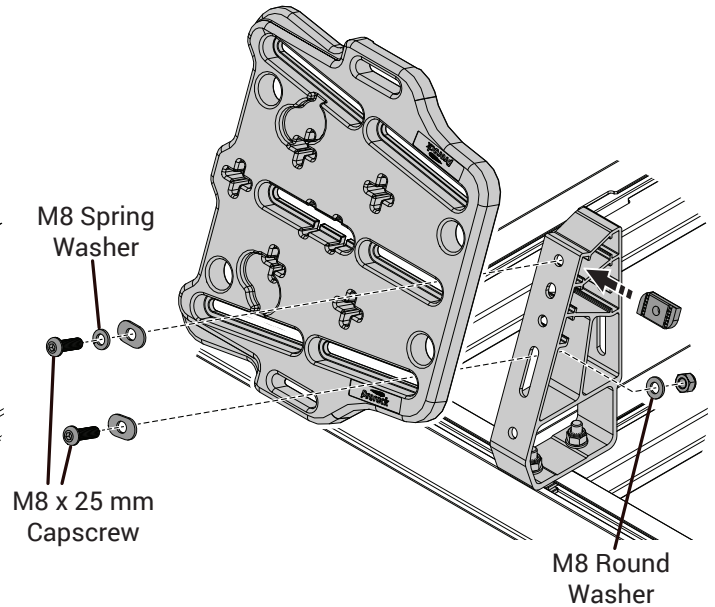

**Vertical Mount High Height Position Assembly.**

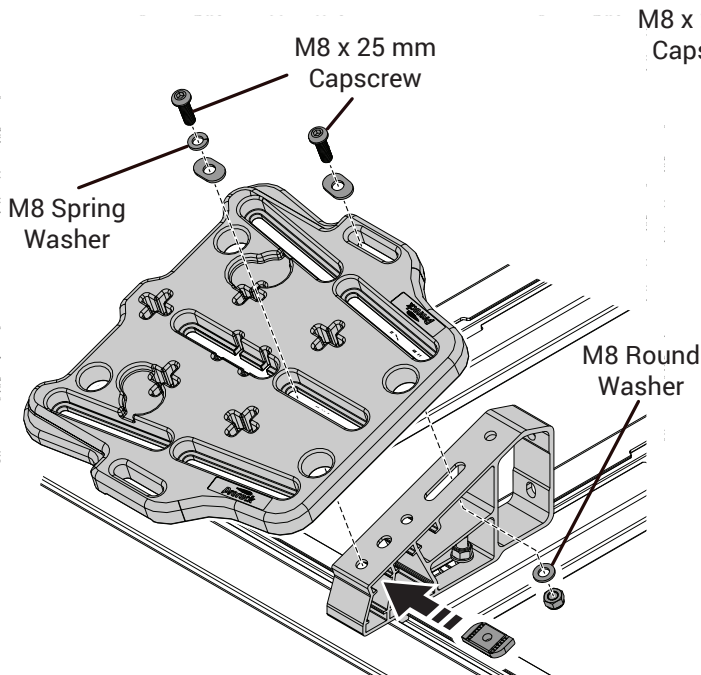

**Shallow Mount Low Height Position Assembly.**

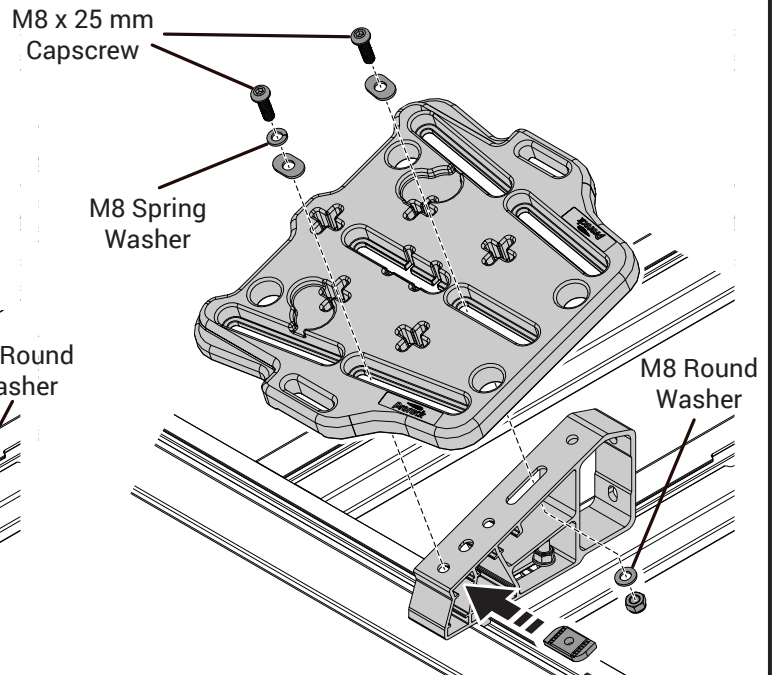

**Shallow Mount High Height Position Assembly.**



## 4 INSTALL STRAPS

Attach straps by hooking the webbing buckles from behind and then through the outer holes on the Baseplates. Ensure that the buckles are sitting flat, as pictured. Also, check that at the velcro on the Adjuster Strap is facing away from the vehicle, and that the velcro on the Fixed Strap is facing towards the vehicle.

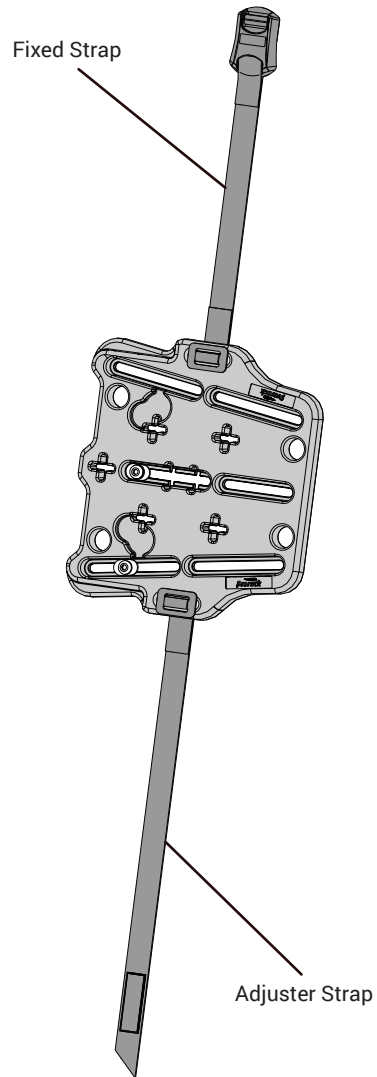
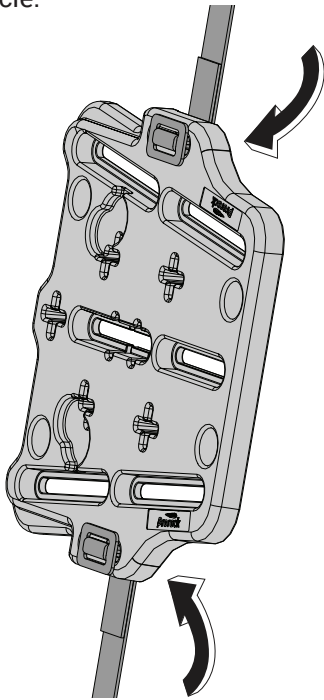

## 5 TIGHTEN STRAPS

Loosely fit Adjuster strap through the cam buckle in the Fixed Strap assembly prior to fitting Recovery Tracks. Insert Recovery Tracks through the loose straps. Locate the crosshairs on your Recovery Tracks into the corresponding cross slots in the Baseplates. Tighten straps firmly and secure the velcro sections.

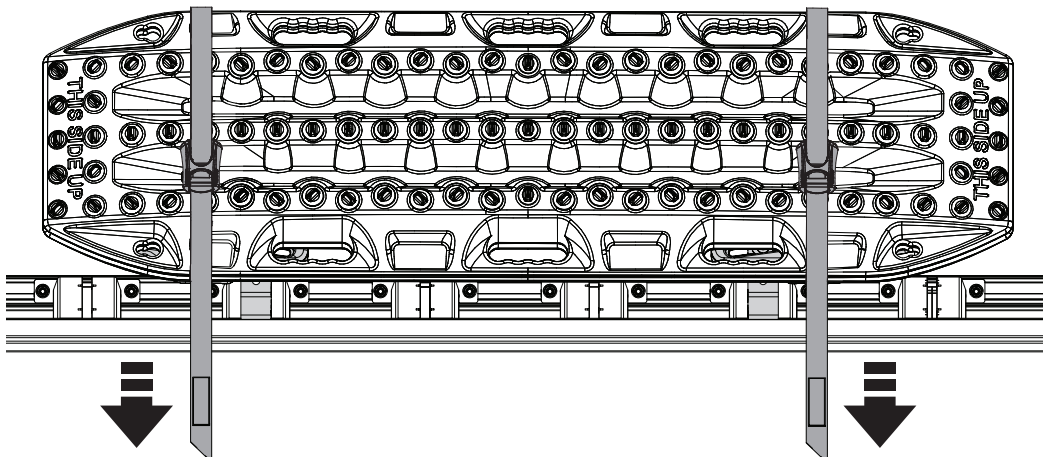
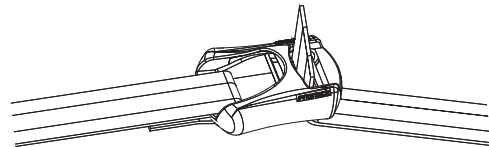

# Baseplate Direct Installation to Prorack Aero Bars

## Direct Flat Mount to Aero Bars

Use T-bolts Washers, and Nyloc Nuts supplied.

### 1 BACKPLATE WIDTH

Measure the distance required between the Backplates.

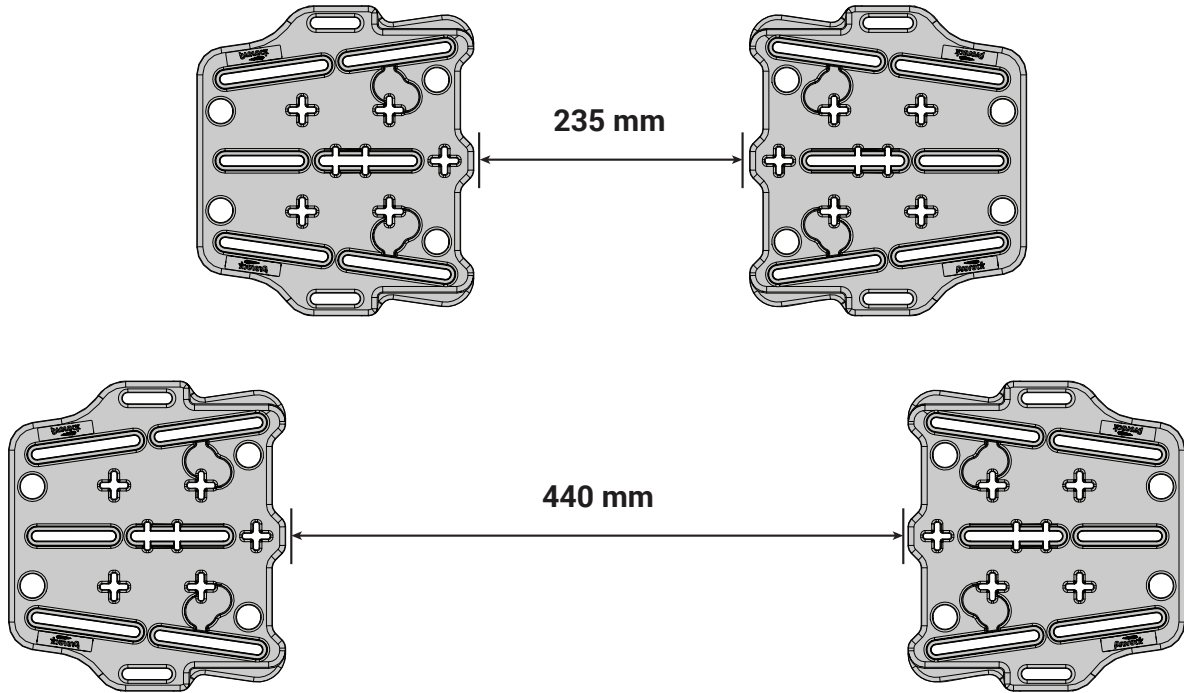

### 2 POSITION T-BOLTS

Insert x2 T-Bolts into the T-Channel of the Aero Bar crossbar. Depress the crossbar infill and slide the T-Bolt Slat to suit the bracket position. Repeat for the second mounting bracket.

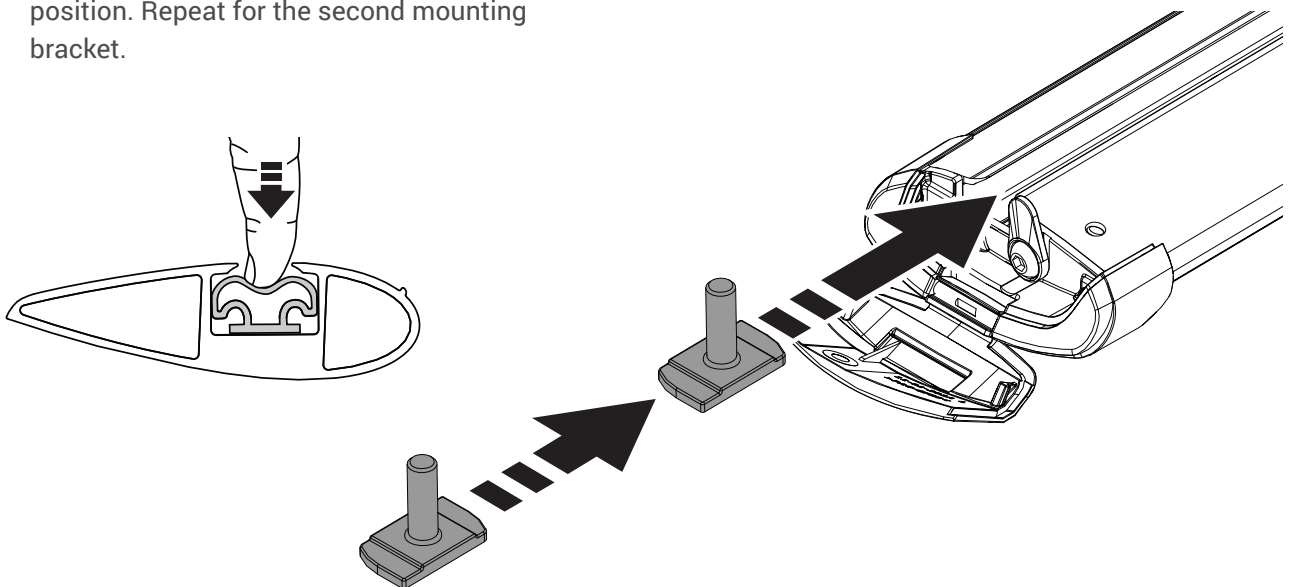

## 2 ASSEMBLE PARTS

Rest the Backplate on the previously installed T-Bolts. Assemble the M8 Oval Washers and M8 Nyloc Nuts onto the Backplate according to your desired mounting position.

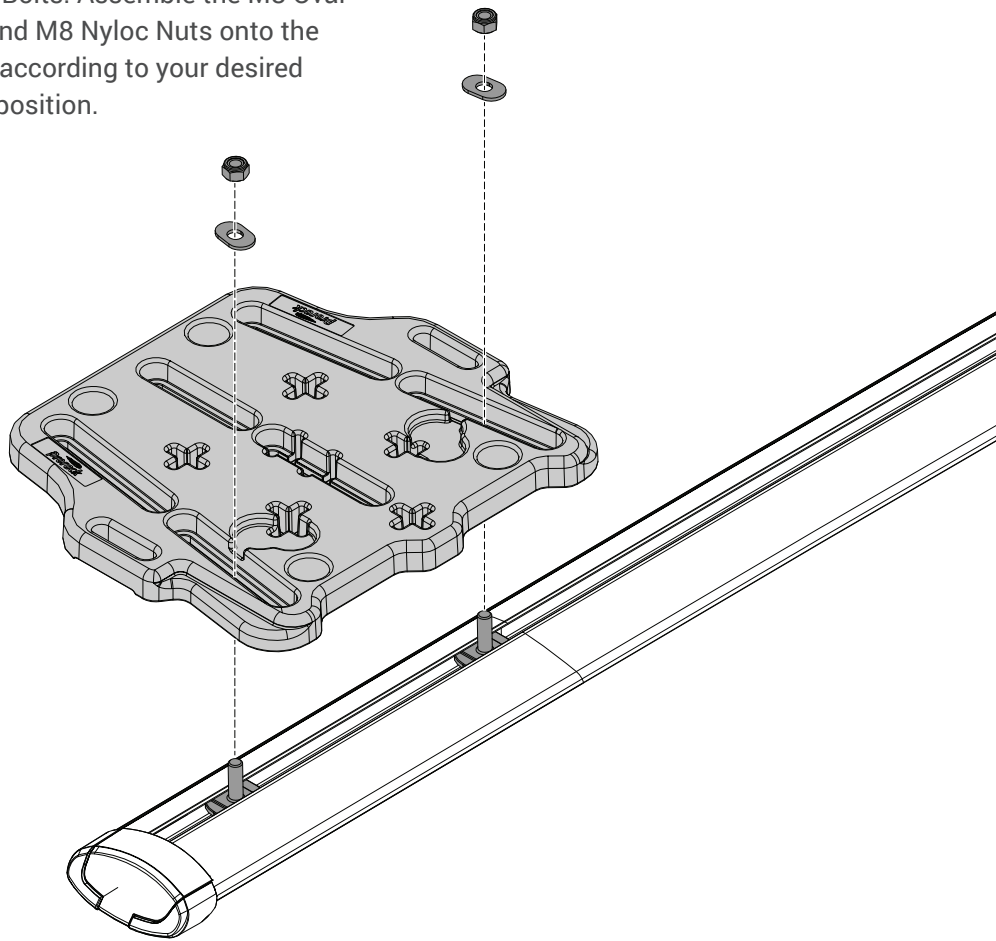

## 3 SECURE

Tighten the fasteners to 4 Nm using a 13mm socket and ratchet.

**Note:** Some 1/2" drive large sockets may not fit into the channel to tighten the nut.

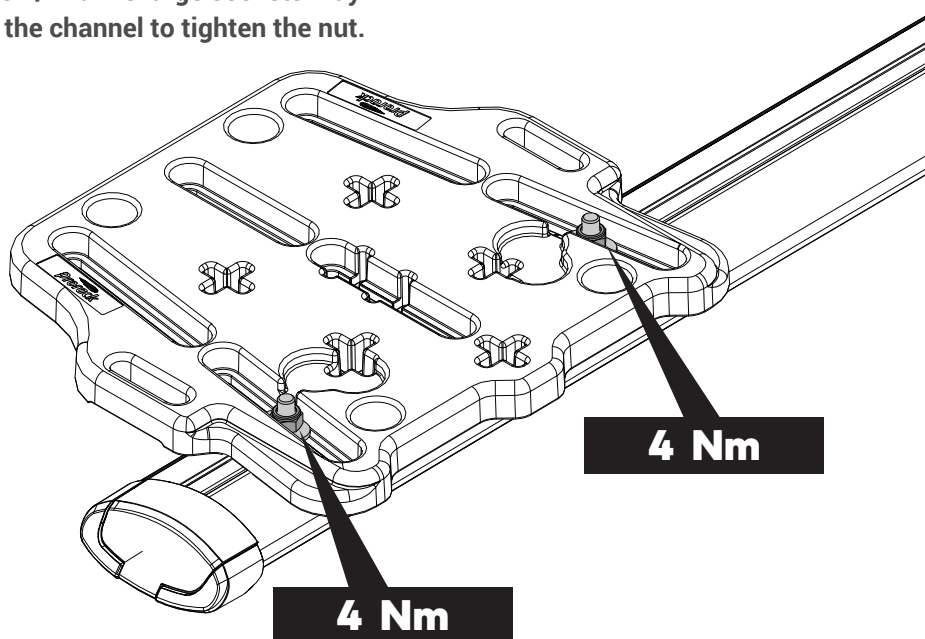

## 5 INSTALL STRAPS

Attach straps by hooking the webbing buckles from behind and then through the outer holes on the Baseplates. Ensure that the buckles are sitting flat, as pictured. Also, check that at the velcro on the Adjuster Strap is facing away from the vehicle, and that the velcro on the Fixed Strap is facing towards the vehicle.

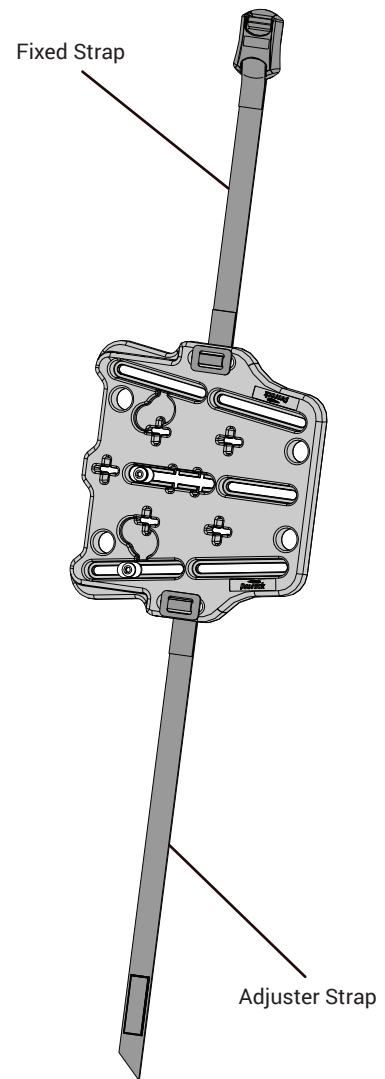
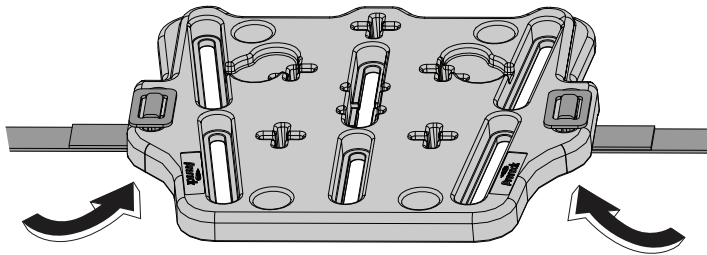

## 6 TIGHTEN STRAPS

Loosely fit Adjuster strap through the cam buckle in the Fixed Strap assembly prior to fitting Recovery Tracks. Insert Recovery Tracks through the loose straps. Locate the crosshairs on your Recovery Tracks into the corresponding cross slots in the Baseplates. Tighten straps firmly and secure the velcro sections.

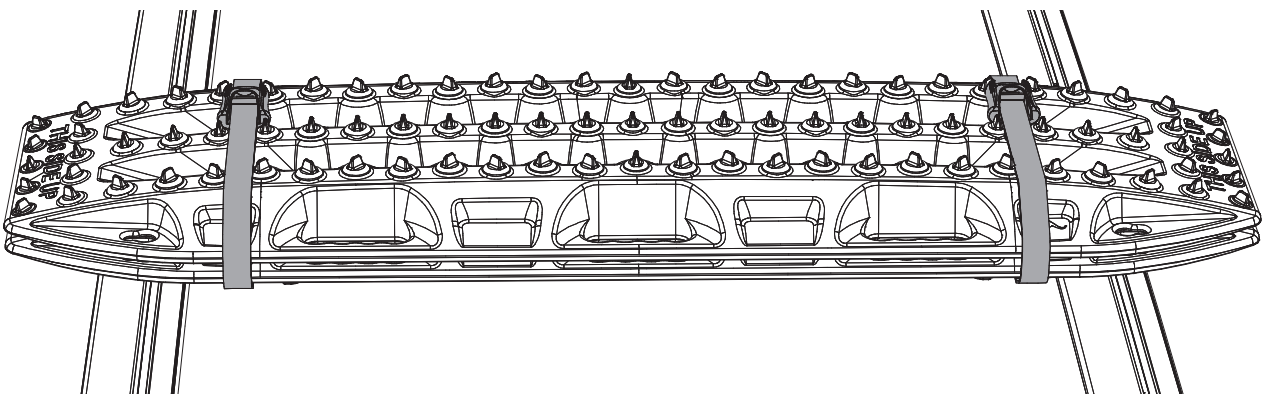
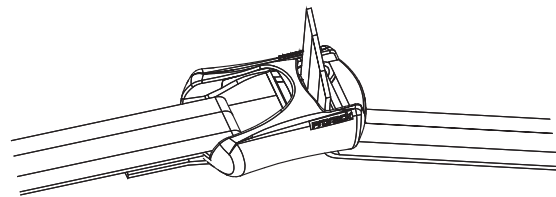

# Baseplate Direct Installation to HD Bars

## Direct Flat Mount to HD Bars

Use T-bolts Washers, Spring washers and Nyloc Nuts supplied.

### 1 BACKPLATE WIDTH

Measure the distance required between the Backplates.

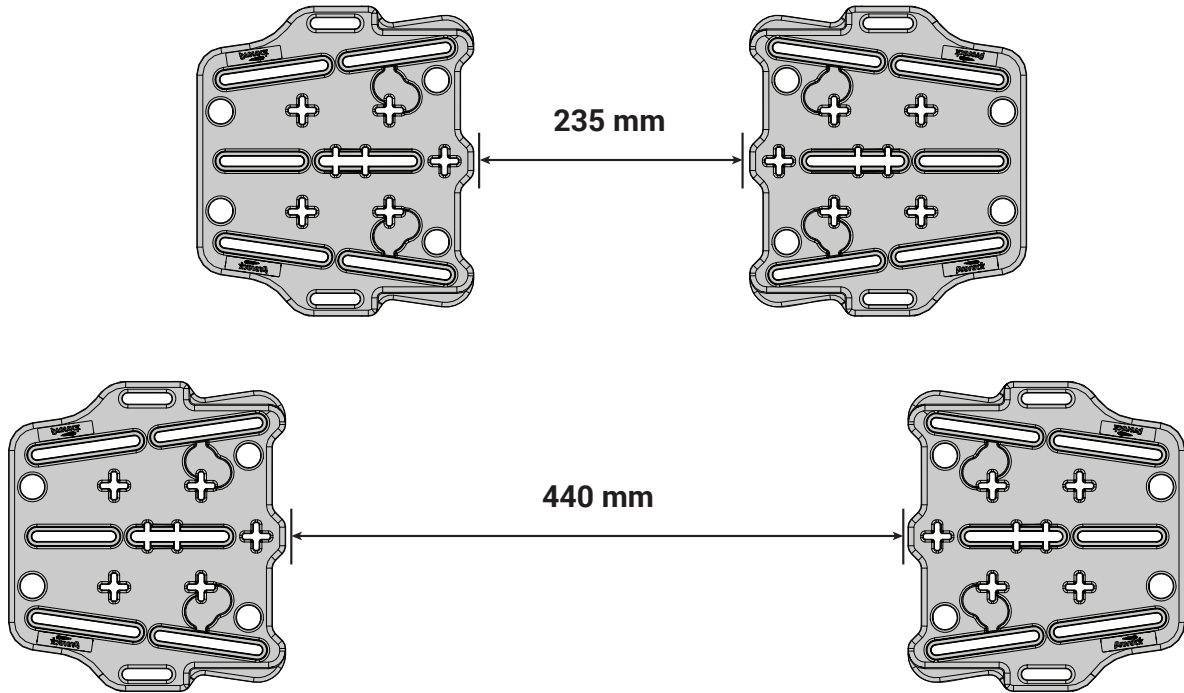

### 2 ASSEMBLE PARTS

Assemble the T-Bolts, M8 Oval Washers and M8 Nyloc Nuts onto the Backplate according to your desired mounting position.

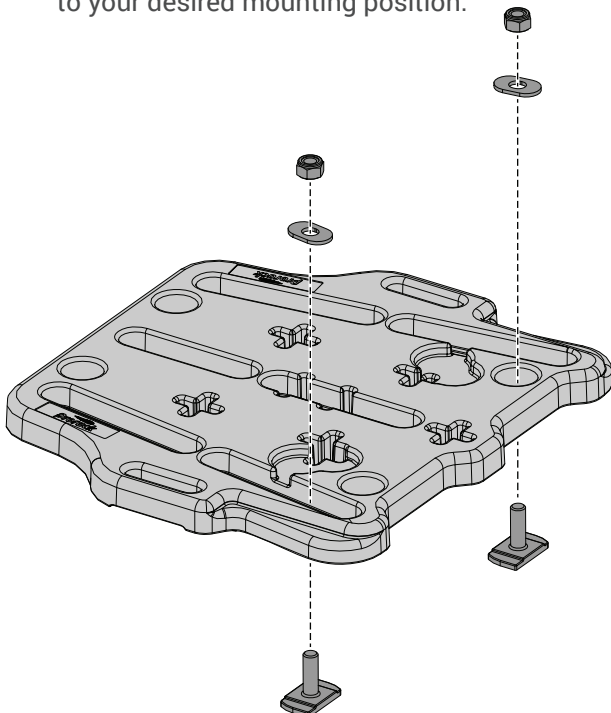

### 3 POSITION BACKPLATE

Rest the Accessory Bracket on the crossbar with the T-Bolt inside the T-Channel.

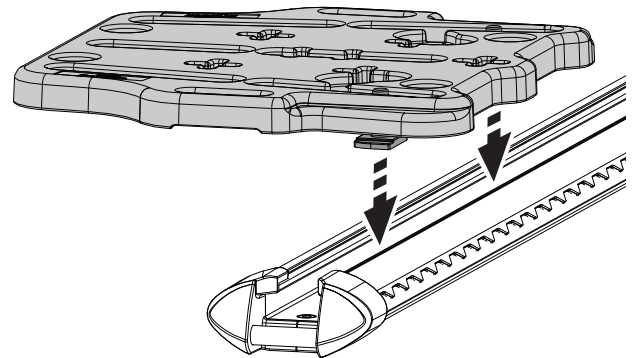

#### 4 ATTACH BRACKET

Rotate the T-Bolt and Slot Nut so that they turn 90° inside the T-Channel.

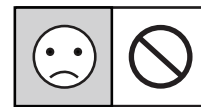
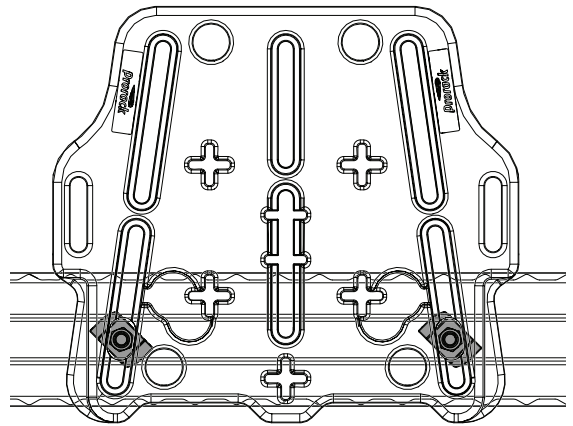
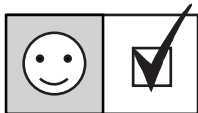
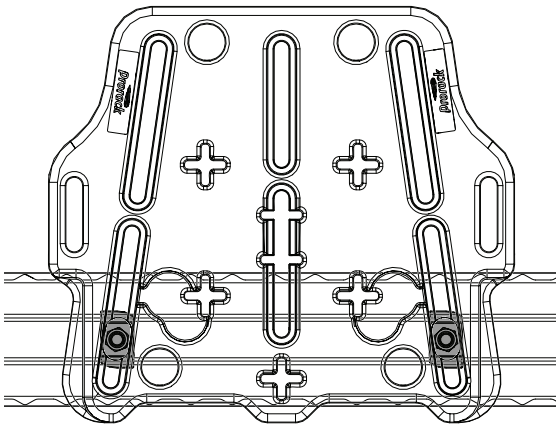
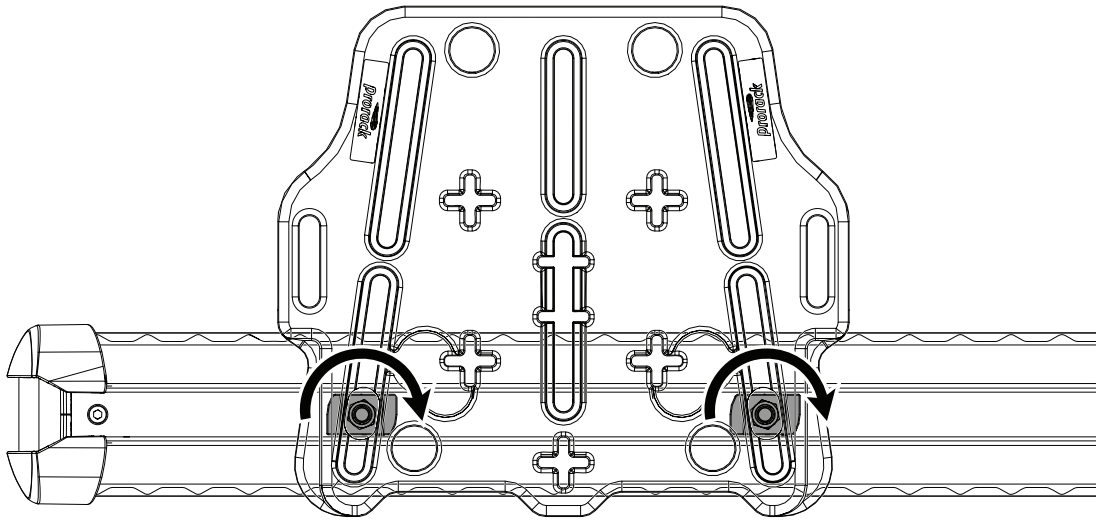

#### 4 SECURE

Tighten the fasteners to 4 Nm using a 13mm socket and ratchet.

**Note:** Some 1/2" drive large sockets may not fit into the channel to tighten the nut.

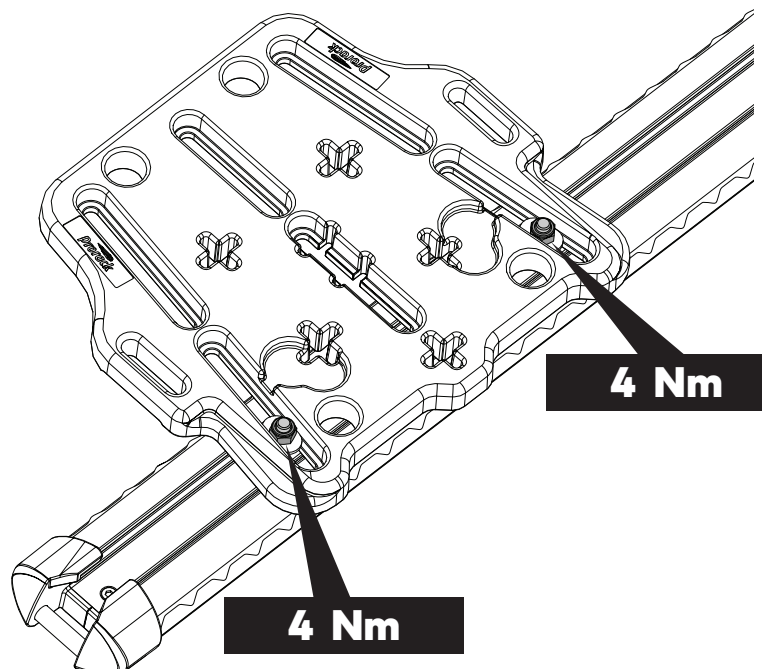



## 5 INSTALL STRAPS

Attach straps by hooking the webbing buckles from behind and then through the outer holes on the Baseplates. Ensure that the buckles are sitting flat, as pictured. Also, check that at the velcro on the Adjuster Strap is facing away from the vehicle, and that the velcro on the Fixed Strap is facing towards the vehicle.

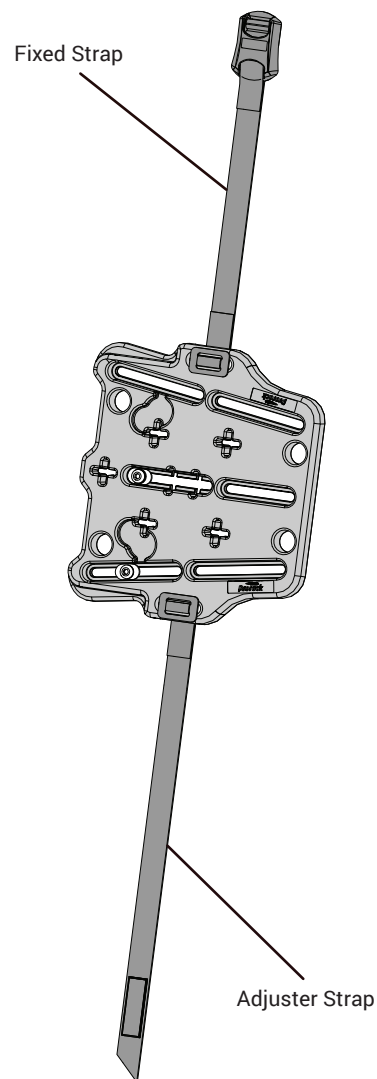
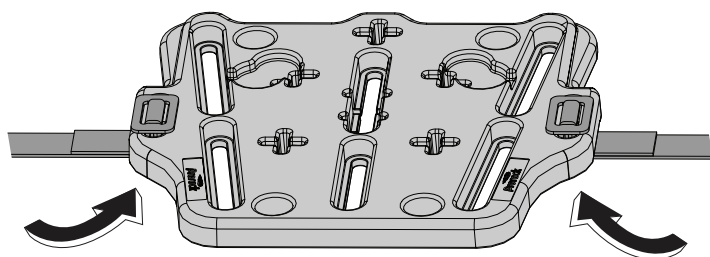

## 6 TIGHTEN STRAPS

Loosely fit Adjuster strap through the cam buckle in the Fixed Strap assembly prior to fitting Recovery Tracks. Insert Recovery Tracks through the loose straps. Locate the crosshairs on your Recovery Tracks into the corresponding cross slots in the Baseplates. Tighten straps firmly and secure the velcro sections.

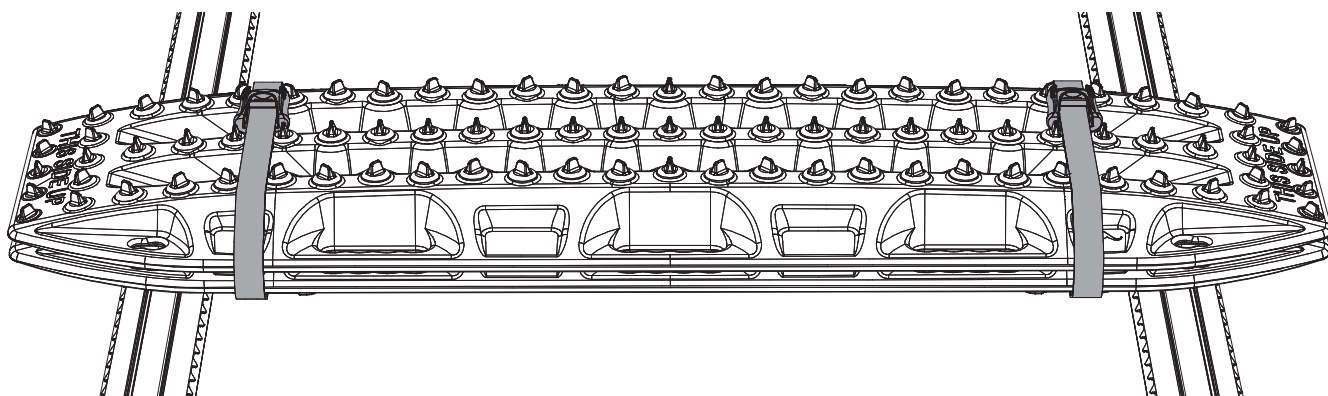
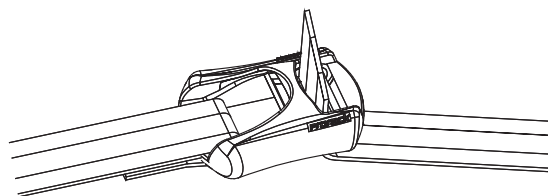



## Locking Cable Installation

### Securing Recovery Tracks using the Locking Cable.

#### 1 USING THE LOCKING CABLE

The Locking Cable can be used to keep your Recovery Tracks safe and secure. Loop around the inside of Crossbar leg or Aero Deck slat and feed through a keyhole on Recovery Tracks. Secure with padlock (not supplied).

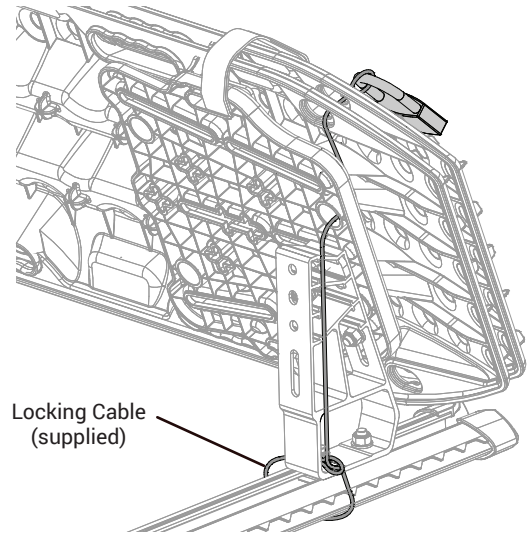

## Optional Accessory Installations



PRORACK ACCESSORIES SOLD SEPARATELY

### Optional Prorack Accessories can be used in conjunction with Prorack Recovery Track Mount.

#### 1 PRORACK UNIVERSAL MOUNT

The Prorack Universal Mount (PR3715) can be mounted onto the back of the Accessory Brackets as shown.

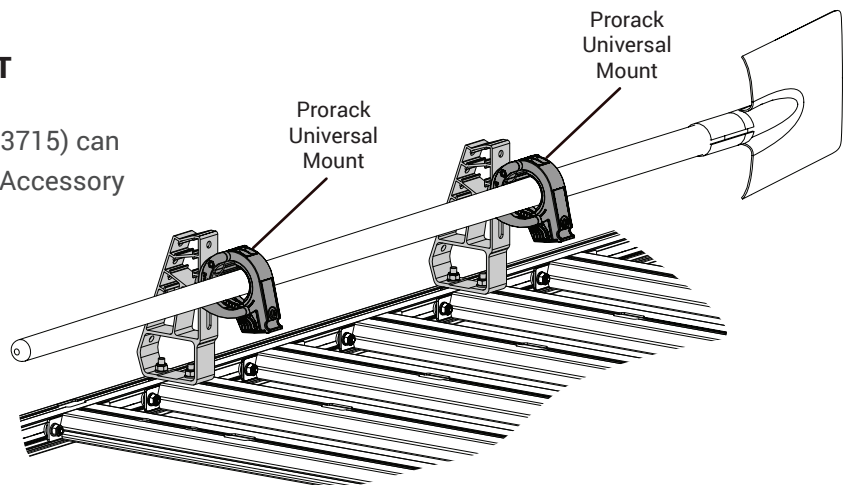

#### 2 PRORACK AWNING BRACKET

The Prorack Awning Bracket (PR3111) can be mounted in tandem with the Accessory Brackets as shown.

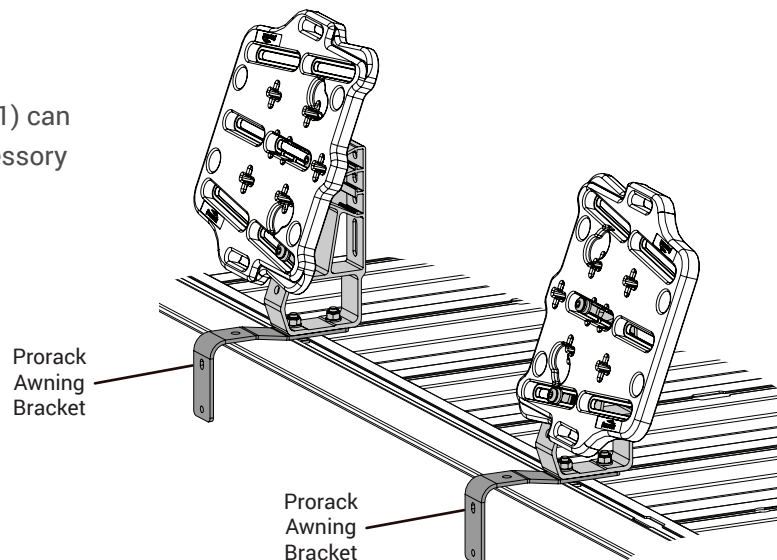

## **Maintenance**

- Check accessory is securely attached whenever you refit it to the vehicle. If the unit feels loose, refer to the fitting instructions and readjust.
- Regularly check all fasteners. This includes all attached accessories and roof racks.
- Remove Straps when not in use.
- Clean with hot soapy water and sponge as required.

## **Caution**

- The Mounting Brackets can carry up to 25 kg of equipment per pair. Ensure all items are securely attached.
- Ensure that all loads are distributed evenly across the roof racks and are fastened securely.
- A loaded roof rack system can alter the performance of your vehicle. Be especially aware of the effects of side winds, changing of direction, and braking performance. Avoid rapid acceleration and deceleration. Drive Carefully.
- Make sure all loads are securely fastened with non-elastic Straps. Check regularly during longer journeys.
- Never drive into a car wash with the roof rack system or accessories fitted.
- Do not exceed the vehicle manufacturer's roof load rating. Total load equals weight of roof racks + accessories + cargo/ equipment.



**Prorack**  
17 Hinkler Court, Brendale  
QLD 4500, Australia

Freephone  
AU: 1800 143 548  
NZ: 0800 4776 722

[www.prorack.com.au](http://www.prorack.com.au)  
[www.prorack.co.nz](http://www.prorack.co.nz)